

**r·pod**  
By Forest River



# r·pod

***By Forest River***





RP189 shown in Sandbar



Available Solar Option includes  
110W Solar Panel, Digital Controller  
and 1000 Watt Inverter

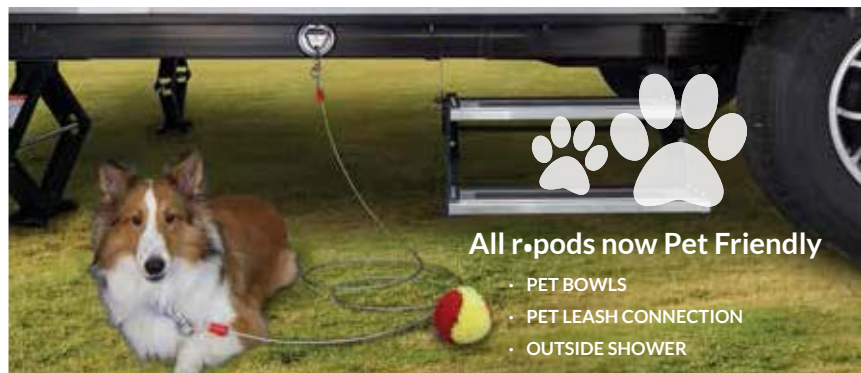

### All r.pods now Pet Friendly

- PET BOWLS
- PET LEASH CONNECTION
- OUTSIDE SHOWER



RP190



RP190 Bath/Lavatory





Optional Exterior Sliding/Removable Kitchen

We want you to be a part of the r•pod adventure! Sure, r•pod is affordable and has the lowest tow weight in its class, but you'll also love its unique shape and construction. This fun pod comes standard with a 3.7 cu. ft. 3-way refrigerator to hold enough for those extended adventures. The interior has residential cabinetry, hardwood drawers and expandable cargo netting to stow movies or games when the elements keep you inside. After a fun-filled day of exploring, enjoy the convenience of the optional, removable outdoor kitchen under the LED lighted awning.



## BEST TOW IN CLASS

- TORSION AXLE W/ INDEPENDENT SUSPENSION
- 15" NITROGEN-FILLED RADIAL TIRES
- SELF-ADJUSTING ELECTRIC BRAKES



Optional Powered Thule Awning with LED Light

3.7

CUBIC FOOT



GAS  
ELECTRIC  
12 VOLT  
REFRIGERATOR

## AZDEL® EXTERIOR CONSTRUCTION



INTERIOR PANEL

INSULATION

AZDEL

FIBERGLASS  
EXTERIOR

## ONE PIECE FIBERGLASS ROOF

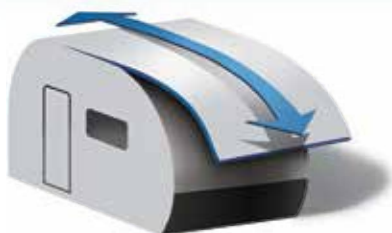

- SEAMLESS
- MAXIMUM RESISTANCE TO WATER INTRUSION
- STRONGEST IN ITS CLASS

36 GAL.  
FRESH WATER

## LARGEST HOLDING TANKS IN CLASS

30 GAL.  
GREY WATER

30 GAL.  
BLACK WATER

**CAMP LONGER**  
FILL & EMPTY YOUR TANKS LESS.





RP191 shown in Starlight



THERE'S MORE TO SEE!



visit  
**ForestRiverInc.com/  
rpod**

for more photos, virtual  
tours and the latest  
model standards  
and options.

**What are you waiting for? Get your adventure started in an *r-pod***  
By Forest River

Photo courtesy of Pete M., Heppner, OR (previous model year r-pod shown)



# FLOORPLANS

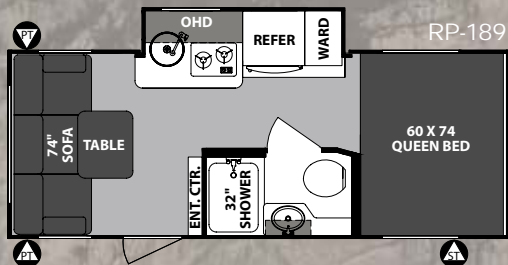
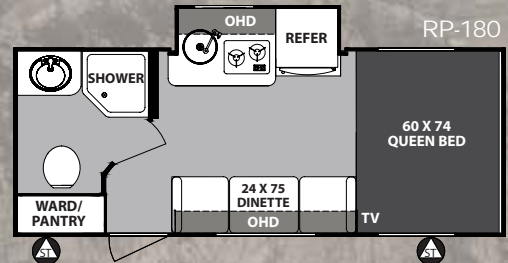
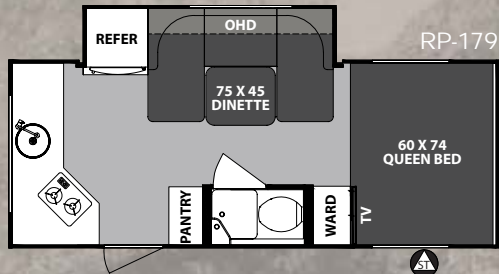
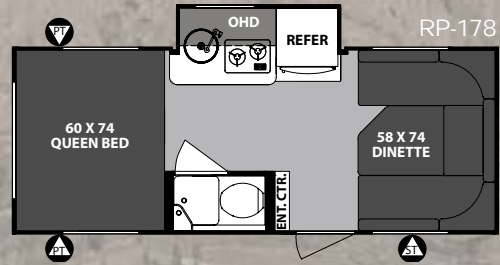
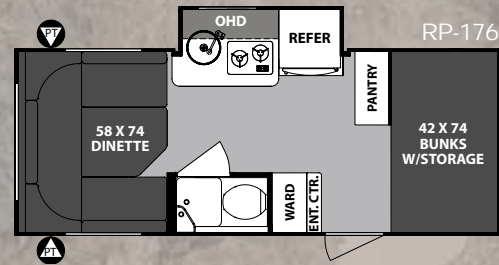
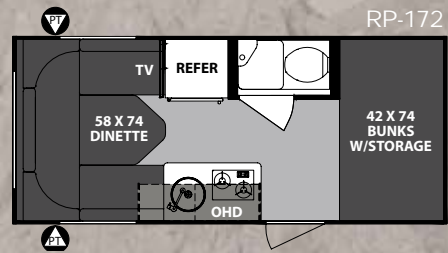
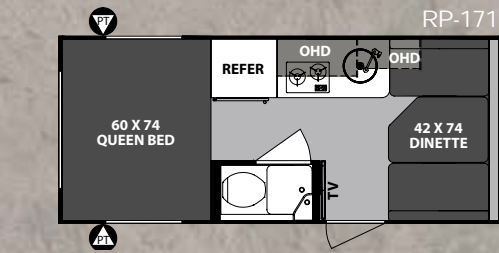

## SPECIFICATIONS

MODEL	RP-171	RP-172	RP-176	RP-178	RP-179	RP-180	RP-189	RP-190	RP-191	RP-192	RP-195	RP-196
Unloaded Vehicle Weight	2504	2497	2959	2893	3046	2950	3075	2979	2952	3449	3587	3600
Hitch Weight	252	250	302	295	315	332	354	307	314	460	362	361
Cargo Carrying Capacity	748	753	843	902	769	882	779	828	862	1411	1175	1161
Exterior Length w/o Spare Tire	18' 4"	18' 4"	20' 0"	20' 0"	20' 0"	20' 0"	20' 4"	20' 4"	20' 4"	22' 2"	22' 2"	22' 2"
Exterior Pod Width	6' 5"	6' 5"	6' 5"	6' 5"	6' 5"	6' 5"	6' 5"	6' 5"	6' 5"	TBD	TBD	TBD
Exterior Overall Width	8' 0"	8' 0"	8' 0"	8' 0"	8' 0"	8' 0"	8' 0"	8' 0"	8' 0"	8' 0"	8' 0"	8' 8"
Exterior Height*	8' 7"	8' 7"	8' 8"	8' 8"	8' 8"	8' 8"	8' 8"	8' 8"	8' 8"	TBD	TBD	TBD
Exterior Height with A/C	9' 6"	9' 6"	9' 7"	9' 7"	9' 7"	9' 7"	9' 7"	9' 7"	9' 7"	9' 8"	9' 8"	9' 8"
LP Capacity (lbs.)	20	20	20	20	20	20	20	20	20	TBD	TBD	TBD
Fresh Water (gal.)	30	30	30	30	30	30	30	30	30	30	30	30
Grey Water (gal.)	30	30	30	30	30	30	30	30	30	30	30	30
Black Water (gal.)	30	30	30	30	30	30	30	30	30	30	30	30

GVWR (Gross Vehicle Weight Rating) - is the maximum permissible weight of the unit when fully loaded. It includes all weights, inclusive of all fluids, cargo, optional equipment and accessories. For safety and product performance do NOT exceed the GVWR.

GAWR (Gross Axle Weight Rating) - is the maximum permissible weight, including cargo, fluids, optional equipment and accessories that can be safely supported by a combination of all axles.

UVW (Unloaded Vehicle Weight)\* - is the typical weight of the unit as manufactured at the factory. It includes all weight at the unit's axle(s) and tongue or pin and LP Gas. The UVW does not include cargo, fresh potable water, additional optional equipment or dealer installed accessories.

\*Estimated Average based on standard build optional equipment.

CCC (Cargo Carrying Capacity)\*\* - is the amount of weight available for fresh potable water, cargo, additional optional equipment and accessories. CCC is equal to GVWR minus UVW. Available CCC should accommodate fresh potable water (8.3 lbs per gallon). Before filling the fresh water tank, empty the black and gray tanks to provide for more cargo capacity.

\*\* Estimated average based on standard build optional equipment.

Each Forest River RV is weighed at the manufacturing facility prior to shipping. A label identifying the unloaded vehicle weight of the actual unit and the cargo carrying capacity is applied to every Forest River RV prior to leaving our facilities. The load capacity of your unit is designated by weight, not by volume, so you cannot necessarily use all available space when loading your unit.

All information contained in this brochure is believed to be accurate at the time of publication. However, during the model year, it may be necessary to make revisions and Forest River, Inc., reserves the right to make all such changes without notice, including prices, colors, materials, equipment and specifications as well as the addition of new models and the discontinuance of models shown in this brochure. Therefore, please consult with your Forest River dealer and confirm the existence of any materials, design or specifications that are material to your purchase decision. 11/19

©Copyright 2019 Forest River Inc - All Rights Reserved.



### PRE-DELIVERY INSPECTION FACILITY

20,000 square feet of quality assurance. The bare essentials for a premium product. This state-of-the-art facility gives immediate daily feedback to production for quality assurance in every unit built.

### CUSTOMER SATISFACTION



[www.ForestRiverBuyLocal.com](http://www.ForestRiverBuyLocal.com)

YOUR LOCAL **r.pod** DEALER  
By Forest River



### 24/7 EMERGENCY ROADSIDE ASSISTANCE WITH VEHICLE PURCHASE\*

TOWING  
JUMP-STARTS  
TIRE CHANGES  
FLUID DELIVERY  
LOCKOUT  
SERVICE

WINCH-OUT  
MOBILE MECHANIC  
TECHNICAL  
SUPPORT  
DEALER LOCATOR  
SERVICES



\*VALID FOR 1 YEAR FROM DATE OF PURCHASE



### Forest River Owner "Digital Kit" App

Now you can have your Owner's Manual with you wherever you are. Download our FREE App from the App Store or Google Play and you'll have the information right at your fingertips.

**FREE MEMBERSHIP**  
to Forest River Owners' Group

[www.forestriverfrog.com](http://www.forestriverfrog.com)



**Learn More**  
Scan this barcode using a QR Reader on your smart phone to learn more about Forest River.



A Berkshire Hathaway company.

**R.pod Division**  
Forest River, Inc.  
2780 College Ave.  
Goshen, IN 46528

**574.537.1452**

[www.forestriverinc.com/rpod](http://www.forestriverinc.com/rpod)  
[www.forestriveraccessories.com](http://www.forestriveraccessories.com)