

Easy-driving
meets easy living.



VITA

QUALITY INNOVATION SERVICE

Viva la Vita

- **FLEXIBLE LOUNGE** Entertain. Play. Or just relax after a day on the road. The Vita's lounge is the perfect place to unwind, with the extra room from the driver's-side slideout, available theater seating and swivel cab seats that let you be part of the party.
- **MERCEDES-BENZ® CHASSIS** The fuel-efficient new chassis offers upgraded safety features like active brake assist, lane-keeping assist and attention assist, plus the MBUX Infotainment Center with voice interface, Wi-Fi hotspot and rear camera. In camp, the available automatic hydraulic leveling jack system levels and stabilizes the coach.
- **MAXIMUM CAPACITY** The Vita tops the Class C Sprinter category with a carrying capacity of up to 1,810 lbs., and features a multipurpose wardrobe and customizable pantry designed for your unique touch.
- **INTERIOR & EXTERIOR STYLE** With two new available interiors and more styling options for your exterior, it's easier than ever to make your Vita feel like home.
- **EXTENDED ADVENTURES** With the largest batteries found in a Class C coupled with standard 200-watt solar panels expandable to up to 475 watts, a 1,000-watt inverter, and a 3,600-watt LP generator, you can bed down without the hookup.

WINNEBAGO

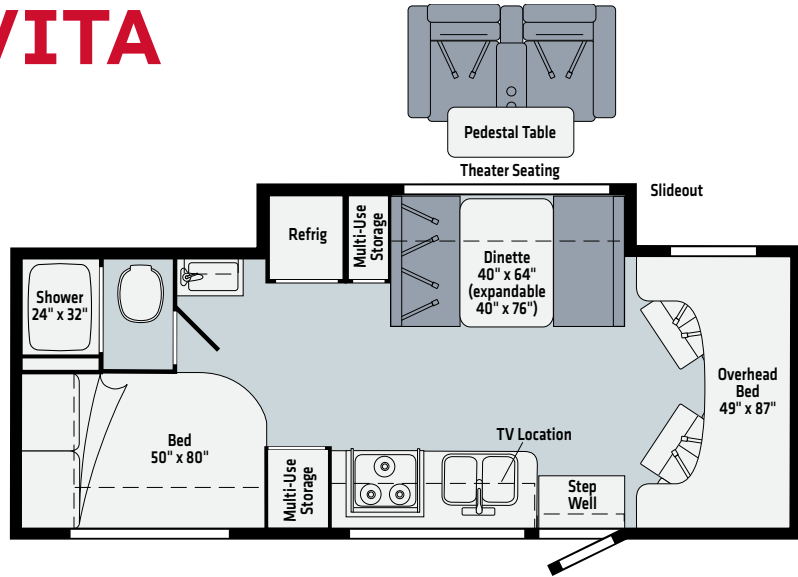

24F

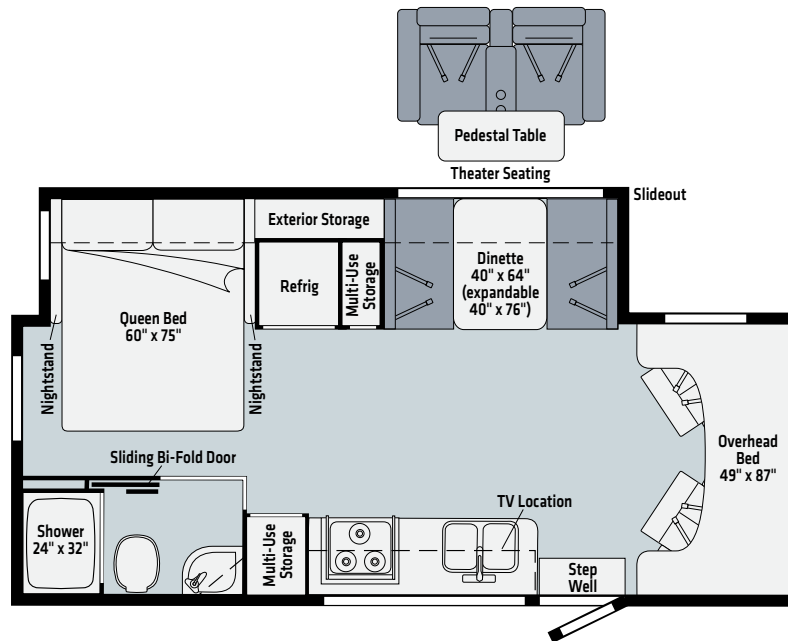

24P

WEIGHTS | MEASURES

	24F	24P
Length	24'5"	24'5"
Exterior Height ¹	11'7"	11'7"
Exterior Width	7'6"	7'6"
Exterior Storage ² (cu. ft.)	42	45
Awning Length	15'	15'
Interior Height	7'	7'
Interior Width	7'3"	7'3"
Freshwater Tank Capacity ³ (gal.)	37	37
Water Heater Capacity (gal.)	6	6
Holding Tank Capacity - Black/Gray ³ (gal.)	41/41	41/41
LP Capacity ⁴ (lbs.)	50.76	50.76
Fuel Capacity (gal.)	24.5	24.5
GCWR ⁵ (lbs.)	15,250	15,250
GVWR (lbs.)	11,030	11,030
GAWR - Front (lbs.)	4,410	4,410
GAWR - Rear (lbs.)	7,720	7,720
Wheelbase	170"	170"

Note: Dimensions shown are for sleeping and shower space only and may vary due to styling differences.

1. The height of each model is measured to the top of the tallest standard feature and is based on the curb weight of a typically equipped unit. The actual height of your vehicle may vary by several inches depending on chassis or equipment variations. Please contact your dealer for further information.
2. The load capacity of your motorhome is designated by weight, not by volume, so you cannot necessarily use all available space when loading your motorhome.
3. Capacities are based on measurements prior to tank installation. Slight capacity variations can result due to installation applications.
4. Capacities shown are tank manufacturer's listed water capacity (W.C.) Actual filled LP capacity is 80% of listing due to overfilling prevention device on tank.
5. Actual towing capacity is dependent upon your particular loading and towing circumstances, which includes the GVWR, GAWR and GCWR as well as adequate trailer brakes. Please refer to the Operator's Manual of your vehicle for further towing information.

Because features, specifications, equipment, and options may vary from those highlighted in this brochure, the buyer is responsible for confirming with the dealer the features, specifications, equipment, and options included on their specific vehicle. In addition, Winnebago's program of continuous product improvement may result in changes to vehicle specifications, equipment, model availability, and price without notice.



Dashed lines denote overhead storage areas. Floorplans and specifications are also available online at Winnebago.com