



BEAVER  
COACHES  
INCORPORATED

**Marquis**



# options

## ENGINE:

- 300 HP 3208T Caterpillar Engine  
MT 647 Allison 4 Speed Transmission  
10R x 22.5 Radial Tires
- 350 HP 6V-92TA Detroit Diesel Engine  
Jacobs Brake  
HT 747 Allison 4 Speed Transmission  
11R x 22.5 Radial Tires

## DECORATOR'S PACKAGE:

- Opera Window Package
- Power Passenger Foot Rest
- Leather/Mate Club Chairs

## LIVING AREA:

- Webasto Heating System  
Rheostat Controls at each Heat Exchanger  
Heated Luggage Bay  
Two Additional Drawers under Refrigerator  
Hinged Sofa Panel is Replaced with Two Drawers
- Premium Residential Stereo  
Receiver/Amplifier  
Dual Cassette Player  
CD Player  
4 Head Stereo VCR  
6 - Speakers:
  - 2 - Living Area
  - 2 - Bedroom
  - 2 - Exterior
- Fire Resistant Safe
- Leather/Mate Club Chairs
- Insulated Windows

- Opera Window Package:  
Opera Windows w/Solid Wood Window Surrounds  
Vertical Blinds (Living Area)  
Swing Arm Reading Lights  
Indirect Lighting w/Rheostat

## CABINETS:

- Oak Cabinets (Natural Finish)
- Walnut Cabinets

## KITCHEN:

- Gaggenau Stove - Recessed with Corian Counter Top
- Corian Counter Top & Sink
- Full Hardwood Floor - Parquet or Plank
- Facing Dinette (Available on Some Models)

## BATHROOM:

- Corian Counter Top & Fiberglass Sink
- Jacuzzi w/Illuminated Skylight & 2 - 10 Gal. Water Heaters (DSI-LP Only)  
Jacuzzi Action w/Standard Tub - (Orlov Only)  
Jacuzzi Action & Tub (Jubilee & Tiffany)
- Ceramic Tile Floor

## EXTERIOR:

- Computerized Air & Hydraulic Leveling System

## COCKPIT:

- Musical Horns
- Power Foot Rest for Passenger's Seat

## INTERIOR COLORS:

- Champagne Beige
- Pearlescent Ivory
- Crystal Grey

## CONSTRUCTION

- High Tensile Tubular Aluminum Framework Throughout
- 1-1/2" High Density Insulation
- Additional Fiberglass Batting Insulation Under Roofcap
- Fiberglass/Balsa Composite Roofcap & Sidewalls

Northside Industrial Area  
20545 Murray Road  
Bend, Oregon 97701

Call *Bob Stone*  
**1-800-423-2837**

# facts about the Marquis

## EXTERIOR LENGTH:

- 37' = 36' 11-1/4"
- 40' = 39' 9-1/2"

## EXTERIOR WIDTH:

- 8 1/2' = without Mirrors
- 10-1/2' = with Mirrors

## INTERIOR HEIGHT:

- 6' 8-1/2"

Measured without Carpet & Pad

## EXTERIOR HEIGHT:

- 11' 9-5/8" with Roof Air Conditioners
- With Air-Ride Set & Top of Frame 37-3/4" Off Floor

## HEAT/AIR:

- Furnance - 42000 BTU
- Toe Space Heater  
Living - 1000W  
Bath - 600W
- Dual Roof Airs - 13500 BTU each

## WHEEL BASE:

- 37' - 228"
- 40' - 262"

## ELECTRICAL:

- Inverter - 2000W
- Converter - 75 Amps
- Batteries  
House - 110 Reserve Amps  
Chassis - 1100 Cold Cranking Amps

## HOLDING CAPACITIES

- Fresh Water - 100 Gallons
- Dual Holding Tank - 78 Gallons each
- LP Gas Capacity - 35 Gallons
- Water Heater - 10 Gallons (20 Gal. w/Orlov)
- Fuel - 150 Gallons



**BEAVER  
COACHES  
INCORPORATED**

For additional information contact:

## COCKPIT

- Deluxe 6-way Power Seats
- Tilt-Telescoping Steering Column
- 18" Leather Covered Steering Wheel
- Full Width Sun Visors
- Vinyl Magazine Holders
- 110V Power Privacy Curtain
- Center Console Snack Tray
- Recessed High Intensity Map Lights
- Driver & Passenger Defrost Fans
- Glove Compartment
- Telephone Jack
- Lift-up Dash Access Lid
- Systems Command Center:
  - Tank Level Monitor
  - Driving Computer
  - Voltage and Current Monitor (AC/DC)
  - Altimeter and Barometer
  - Temperature Monitor w/Road Ice Warning Clock
  - Security System
  - Bulb Out Monitor
  - Chassis and Generator (Service Due & Hours)
  - Exterior Flood Light Controls
- Dash Air/Heat Combination
- AM/FM/MPX Cassette Stereo w/Clock
  - 6 Speakers:
    - 2 - Under Dash,
    - 2 - Living Area,
    - 2 - Exterior
- High Performance CB

## BATHROOM

- Plush Carpet w/Pad
- Color-Coordinated Wallpaper
- Ceramic Tile Countertops w/Mirrored Walls
- Insulated Skylight
- Ceramic Toilet w/Sprayer
- Color-Coordinated Fiberglass Shower\*
- Color-Coordinated Tub/Shower w/Two Water Heaters (Standard on Orlov only)
- Electric Toe-Space Heater for Additional Comfort
- Remote Switch Operated 3-Speed Ventilator Fan
- Wardrobe Closet\*
  - Cedar Lined
- Residential Style, Mirrored Pocket Doors with Locks
- Clothes Hamper
- Adjustable Shower Head & Spray Hose Assembly w/Shower Head Shut-Off
- Deluxe Lavy Faucet w/Fiberglass Sink
- Polished Brass Fixtures
- Micro Mini Blinds\*
- Linen Closet\*

\*Depending on Model

## LIVING AREA

- Plush Carpet w/Pad
- Designer Coordinated Interior Color Schemes
- Solid Oak Cabinetry w/Medium Walnut Watco Oil
- Recessed 12V Fluorescent Ceiling Lights
- Wood Mini Blinds
- Sofa Bed with Hinged Sofa Kick Panel for Storage Access
- Fabric Club Chairs w/Arm Covers
- Snack Table with Built-In Magazine Rack
- 4 Head VCR
- 12V TV Signal Boost
- 13" Remote Control Color TV on a Manual Lift-up Tray
- Portable Vacuum Cleaner
- Ducted Forced Air Furnace w/Electronic Ignition
- Decorator Pillows
- Aisle Lights
- Electric Toe Space Heater for Additional Comfort
- Oak End Table\*
- Residential Ducted Air

\*Depending on Model

## BEDROOM

- Wardrobe Closet\*
  - Cedar Lined
- 13" Remote Control Color TV
- Digital Alarm Clock
- AM/FM/MPX Cassette Stereo w/2 Speakers
- 12V Swing Arm Reading Lights
- Telephone Jack
- Micro Mini Blinds
- Queen Size Posture Center Foundation Mattress
- Decorator Bedspread & Pillows
- Electric Blanket Outlet

### **CHASSIS & MECHANICAL**

- Custom Gillig Chassis
- Tires & Wheels
  - 10R × 22.5 Radial
  - Alcoa Aluminum Wheels
- Wheel Base:
  - 40' - 262"
  - 37' - 228"
- 3208T Turbo Charge Caterpillar Diesel Engine -
  - 250 HP at 2600 RPM; 750 Ft. Lbs. Torque at 1,400 RPM
- Allison MT643 4-Speed Auto Transmission
- Leece-Neville 12 Volt, 160 Amp Alternator
- Front Suspension - Gillig Proprietary Air-Ride w/Full Anti-Sway Bar & Koni Shock Absorbers
- Rear Suspension - Neway Air-Ride & Shock Absorbers
- Steering - TRW - Ross Integral Power Steering w/Tilt Head Steering Column
- Turbo Blanket Package for Noise Suppression & Heat Protection
- Dual Air Brake System
- Fully Shrouded Inner Wheel Wells
- Mud Flaps (Front & Rear)
- High Strength Composite Bumpers
- Heavy-Duty Engine Cooling
- Heavy-Duty Transmission Cooler
- Four-Point Heavy-Duty Hydraulic Levelers
- Heavy-Duty 12V 8D Diesel Chassis Battery on Slide-Out Tray
- Heavy-Duty Battery Isolator
- Engine Preheat for Temperatures Below Freezing
- Air Chuck in Passenger Front Storage Compartment for Emergency Charging
- Electronic Shifter/Cruise Control

Due to constant product improvements, prices and specifications are subject to change without notice.

## KITCHEN

- Parquet Flooring
- Micro Mini Blinds
- 8 cu. ft. 3-way, Automatic Energy Selector Refrigerator - Raised Wood Panel Face
- Ice Maker - Raised Wood Panel Face
- Four-Burner Range
- Microwave/Convection Oven w/Lighted Hood
- Large Stainless-Steel Double Sink w/Corian Cover
- Ceramic Tile Countertops and Backsplash
- Built-in Trash Container Rack
- LP Gas/110V Electric Direct Spark Ignition Water Heater
- Dual Water Filtration System
- Demand Water System w/Accumulator Tank for Consistent Pressure
- Thermostatically Controlled Ventilator Fan (3-Speed)
- 110V Fluorescent Ceiling Light Fixture
- Pantry
- Solid Oak Large Dinette Table w/2 Oak Chairs
- 110V Decorative Dining Light
- Bar Cabinet with Crystal

## SAFETY/CONVENIENCE

- Smoke Detector
- Fire Extinguisher
- Seat Belts (Driver, Passenger, & Sofa)
- L.P. Detector System w/Automatic Shut-off
- Back-Up Alarm w/Backing Lights
- Water System w/Freeze Protection
- Battery Disconnect w/250 AMP Battery Fuse Link
- Emergency Towing Package
- Emergency Exit Windows
- Rear View Monitor
- Boost Start System
- 4 Maintenance-free Deep-Cycle, Coach Batteries on Slide-Out Tray
- Roof Mounted Solar Panel for Continuous Coach Battery Trickle Charging
- Heart Interface Inverter/Converter (Battery Charger)
- 12 VDC Distribution Circuit Breaker Panel
- 110 VAC Distribution Circuit Breaker Control Panel
- 12 VDC Chassis Circuit Breaker Panel
- Exterior Utility Box:
  - Easy Access for Exterior Power Hook-Ups
  - TV & Telephone Cable Hook-Ups
  - 50 AMP External Power Connector (Recessed)



## MARQUIS WARRANTY

One (1) year to original owner. Subject to restrictions and/or extensions as stated in manufacturer's manuals.

## EXTERIOR

- Entry Area:
  - Automatic Two Step Entry
  - Large Entry Light
  - Illuminated Entry Handle
  - Illuminated Door Bell
- Windshield Area:
  - Tinted Windshield
  - Dual Motor Intermittent Windshield Wipers w/Washers
  - Power, De-Fog Driving Mirrors w/Turn Signal
- Lights:
  - Clearance Lights
  - Sealed Beam Docking Lights
  - Quartz Halogen:
    - Driving Lights
    - Headlights
    - Fog Lights
    - Backing Lights
- Roof:
  - TV Antenna
  - 2 - Low Profile Air Conditioners (Ducted)
  - Dual Air Horns
  - Roof Rack and Ladder
  - Remote Control Spot/Flood Light
- Storage:
  - Lighted/Vented/Carpeted Storage Compartments - Pass-Through Cargo Area, TV Hook-Up, 12V Outlet, and 110V Receptacle (Inside Patio Storage Compartment)
- Dump Valve Compartment:
  - Water Pump On/Off Switch
  - Water Fill
  - Hot/Cold Faucet
  - Holding Tank Flush System
  - 19' Sewer Hose
- Other:
  - Color-Coordinated Patio & Window Awnings
  - Full Automotive Undercoating
  - Complete Trailer Hitch Package
  - 7.5 KW Onan Diesel Generator
  - Custom Aluminum Grill (Front & Rear)



**40 FT.**

**Special Standard Features**

- Center Hall
- Table & Chairs
- Pantry
- Bar: 4 Wine Glasses;  
6 Whiskey Glasses
- 78" Sofa/Bed w/Arm Covers
- Shirt Closet
- Tilt-out Hamper
- Tub/Shower with 2 - 10 gal. Water Heaters (1 - DSI Gas/Electric,  
1 - DSI-LP Only)
- Jacuzzi (optional)

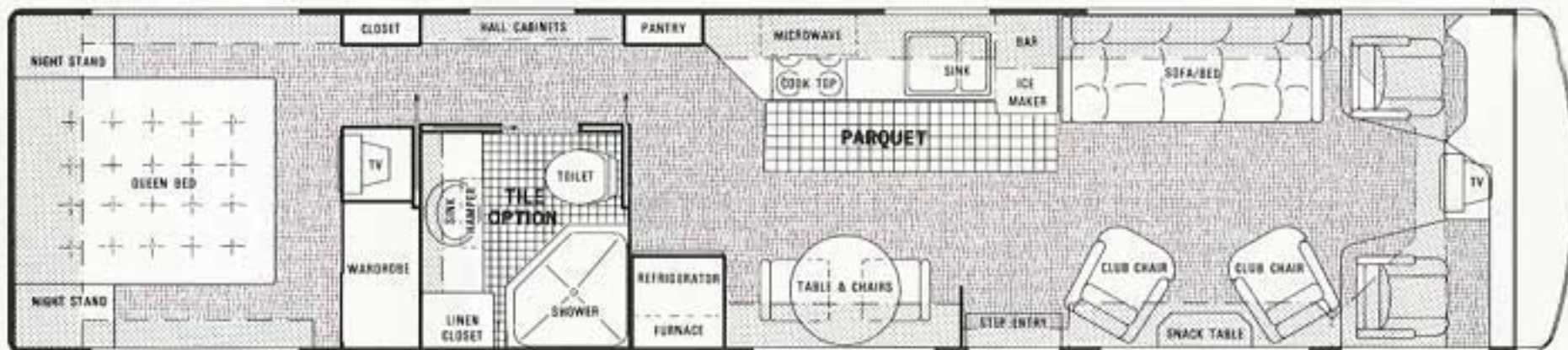

**40 FT.**

**Special Standard Features**

- Sidehall Cabinets
- Table & Chairs
- Facing Dinette (optional)
- Pantry
- Bar: 4 Wine Glasses;  
6 Whiskey Glasses
- 78" Sofa/Bed w/Arm Covers
- Linen Closet
- Tilt-out Hamper
- 36" Shower
- Jacuzzi - optional (Eliminates  
Hamper, Linen Closet and some  
Drawer Storage)



# Marquis®

by Beaver Coaches Inc.