

A NEW ERA IN ULTRA LITES

BULLET

EASTERN EDITION **ULTRA LITE**
by Keystone



www.keystonerv.com/Bullet





BULLET 272BHS SHOWN IN SADDLE DECOR



EASY TO TOW WITH THE NEW MORE FUEL EFFICIENT CROSSOVERS, CARS AND TRUCKS, THE BULLET ULTRA LITE TRAVEL TRAILER HERALDS IN A NEW GENERATION OF RVs.

Sleek and smooth on the outside and loaded with features and conveniences inside, the new Bullet Ultra Lite will set you free to explore the open road.

www.keystonerv.com/bullet

BULLET
ULTRA LITE
by Keystone



BULLET 272BHS KITCHEN STORAGE



BULLET 272BHS BUNK BEDS



BULLET 272BHS BATHROOM



EXTERIOR KITCHEN
(AVAILABLE ON 243BHS, 287QBS, 308BHS)



**THE INDUSTRY'S FIRST LUXURY
ULTRA LITE NOW HAS DEEPER
SLIDES AND MORE FEATURES!**

← 3 FEET WIDE! →

BULLET 269RLS SHOWN IN SADDLE DECOR



BULLET 269RLS SOFA AND DINETTE SHOWN IN SADDLE DECOR

**CONVENIENCE,
COMFORT & STYLE**

**LAUNDRY CHUTE IN EVERY
BULLET FLOOR PLAN**



BULLET 269RLS BEDROOM SHOWN IN SADDLE DECOR



BULLET 269RLS KITCHEN SHOWN IN SADDLE DECOR

BULLET'S TOP FEATURES

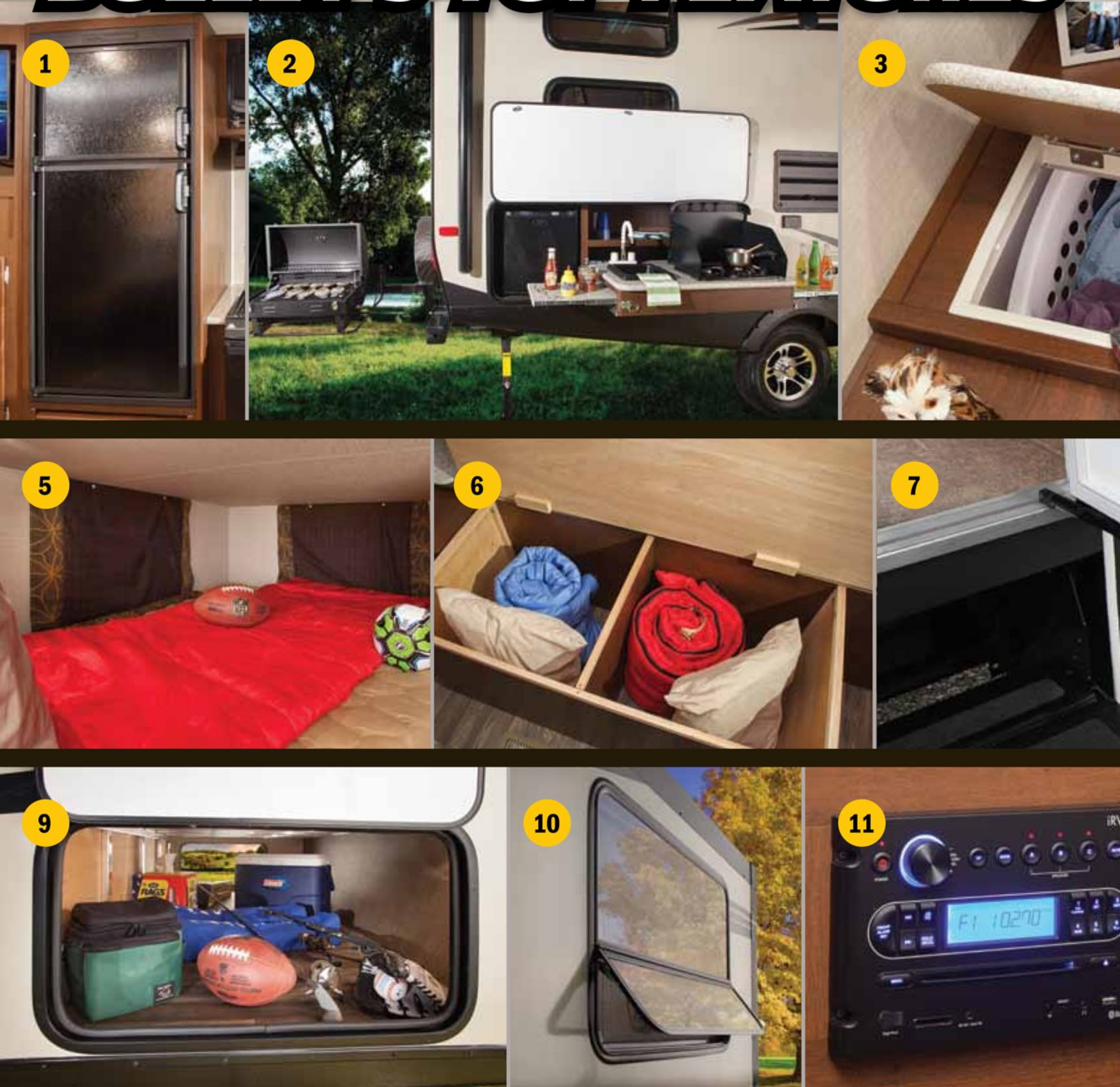

Bullet is the only ultra lite travel trailer to offer the following climate control features in all floor plans:

BULLET	COMPETITION
Enclosed underbelly	Exposed Tanks
2" pipe off of furnace with forced air into underbelly and radiant heat	Radiant heat Only
30,000 BTU Furnace	20,000 - 25,000 BTU Furnace
Ducted Heat and A/C	Non Ducted Heat and A/C

1. 6 cu. ft. Refrigerator
2. Exterior Kitchen (243BHS, 287QBS, 308BHS)
3. Laundry Chute in Master Bedroom
4. Systems Monitor Panel
5. Blackout Shades in Bunk Rooms
6. Storage Underneath the Bed in Master Bedroom

Includes more standard features that matter in light weight travel trailers.



7. Gas Struts on Entry Doors
8. 9" Deep Single Basin Kitchen Sink (N/A 220RBI, 310BHS)
9. Largest Pass-Thru Storage in Class (40.3 cu. ft.)
10. Jalousie Windows
11. CD/DVD/AM/FM/MP3/Bluetooth Stereo
12. Electric Adjustable Awning
13. Hot/Cold Exterior Shower

OVERBUILT OVERPRICED



LARGE RADIUS DINETTE

BULLET

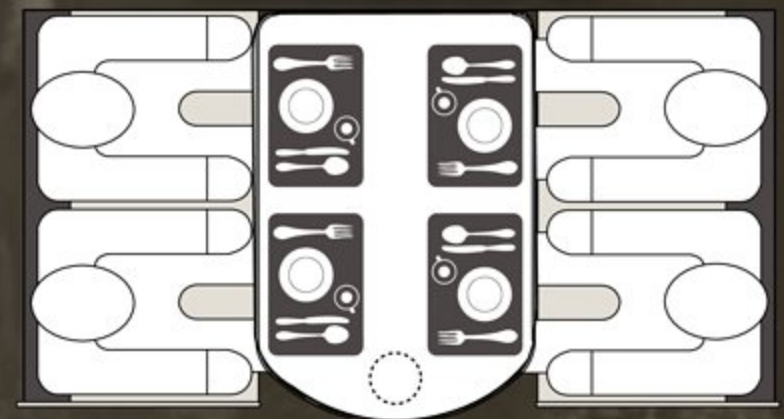

**COMFORTABLY
SEATS 4 ADULTS**

- PLENTY OF ROOM FOR 4 PLACEMATS
- ONLY NEEDS ONE TABLE SUPPORT
- CONVERTS TO 80" BED

COMPETITION

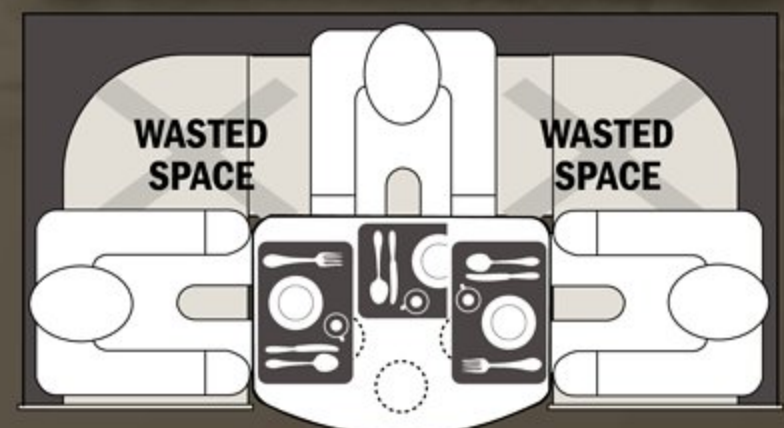

**DON'T BE FOOLED!
ONLY SEATS 3 ADULTS**

- ONLY ENOUGH ROOM FOR 2.5 PLACEMATS
- 3 PEDESTAL SUPPORTS REDUCE LEG ROOM
- ALSO CONVERTS TO 80" BED

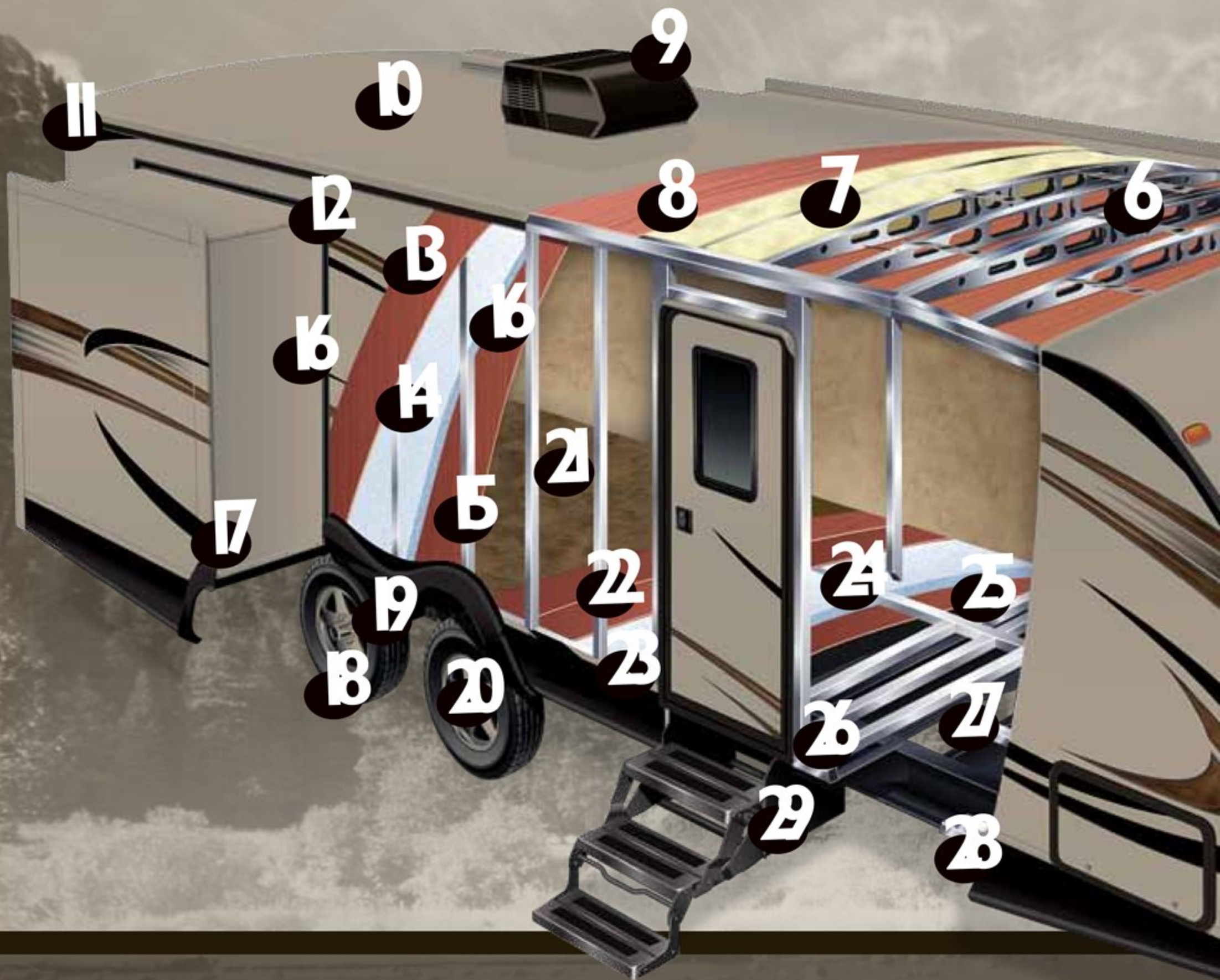

BEST TOWING TRAVEL TRAILER IN THE INDUSTRY

Increased MPG and Easier to Tow



REAR AIR DEFLECTOR

Increases efficiency of wind flow underneath and behind the trailer



ENCLOSED UNDERBELLY

Eliminates turbulence caused by exposed frame members, holding tanks, plumbing etc.



AIR DEFLECTOR

Wider base greatly reduces sway and bouncing

BULLET

ULTRA LITE

by Keystone

LIGHTWEIGHT SOLID CONSTRUCTION



1. Quick Access LP Cover
2. Integrated Dual Battery Tray
3. Diamond Plate Stone Guard
4. Aerodynamic Front Profile
5. Hurricane Straps
6. 5" Radius Galvanized Stamped Steel Roof Trusses
7. Fully Insulated Roof
8. Durable Roof Decking
9. 13.5 Quick Cool Air Conditioning
10. One Piece TPO Roof
11. Full Length Rain Gutter and 4" Drip Spouts
12. Smooth Fiberglass Exterior
13. 1/8" Luan Wall Backing
14. Hi-Density Block Foam Insulation
15. 1 1/2" Box Welded Aluminum Frame Structure
16. Decorative Interior Wall Board
17. Bullet's Multi Seal and Track Slide System
18. Radial Tires with Electric Brakes (4)
19. Wide Stance Axle System
20. Easy Lube Axles
21. Residential Stain Resistant Trek Linoleum (resistant to cold cracking)
22. Plyveneer Floor Decking (water resistant)
23. Hi-Density In Floor Block Foam Insulation
24. Double Welded Aluminum Floor Joists
25. 3rd Layer Floor Decking
26. 6.5" - 10" Steel I-Beam Frame
27. Darco Moisture Barrier Wrap
28. Heated and Enclosed Underbelly
29. Radius Triple Entry Steps



Our lightweight floor plans are 1000-1500 lb. lighter than comparable competitors trailers



The radius front profile of the Bullet travel trailer gives the optimal contour to reduce wind resistance when traveling down the road.

BULLET

ULTRA LITE
by Keystone



220RBI



243BHS



248RKS



272BHS



269RLS



310BHS

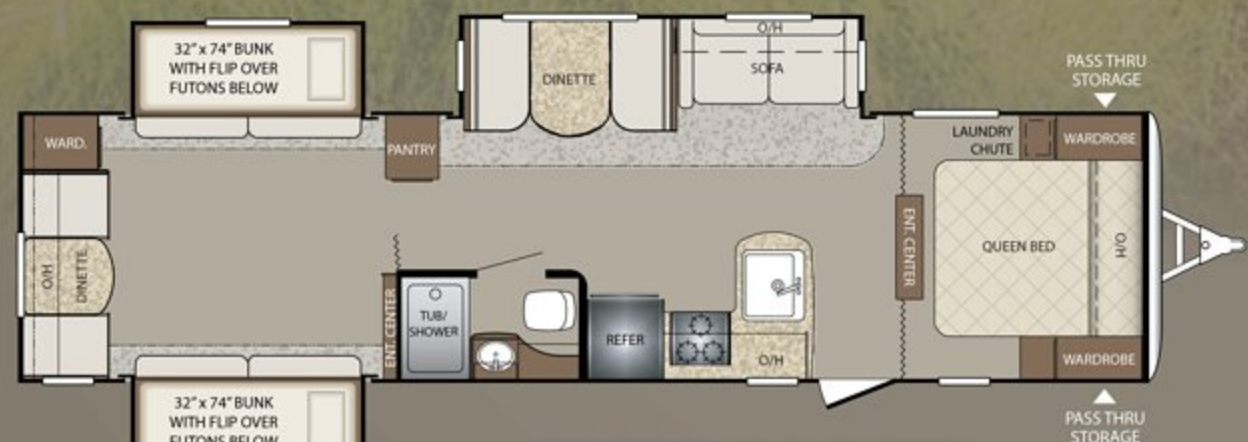

335BHS

Product information is as accurate as possible at the date of publication of this brochure. Features, floor plans, and specifications are subject to change without notice. Please also consult Keystone's web site at keystonerv.com for more current product information and specifications. Tow Vehicle Disclaimer. CAUTION: Owners of Keystone recreational vehicles are solely responsible for the selection and proper use of tow vehicles. All customers should consult with a motor vehicle manufacturer or their dealer concerning the purchase and use of suitable tow vehicles for Keystone products. Keystone disclaims any liability or damages suffered as a result of the selection, operation, use or misuse of a tow vehicle. KEYSTONE'S LIMITED WARRANTY DOES NOT COVER DAMAGE TO THE RECREATIONAL VEHICLE OR THE TOW VEHICLE AS A RESULT OF THE SELECTION, OPERATION, USE OR MISUSE OF THE TOW VEHICLE.

TRAVEL TRAILER FLOOR PLANS

You'll find a Bullet floor plan to fit your lifestyle perfectly.



251RBS



252BHS

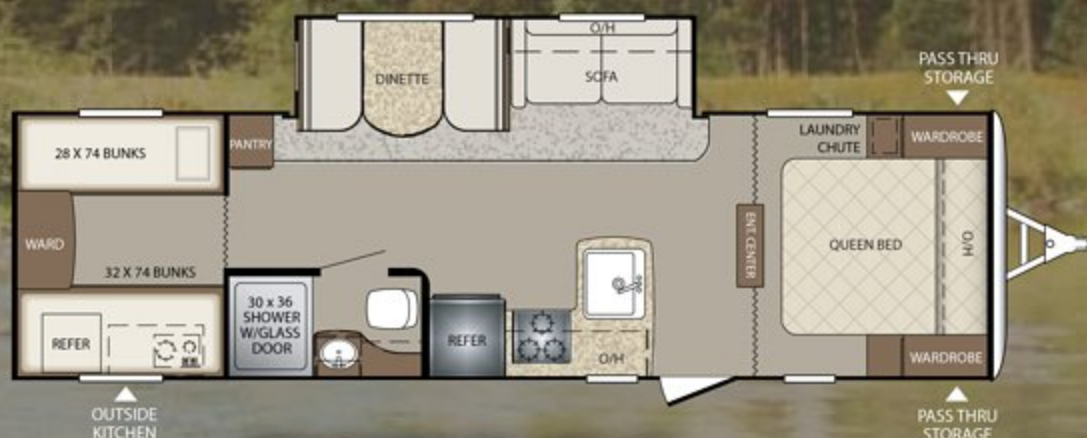

287QBS



308BHS

WEIGHTS & MEASUREMENTS

TRAVEL TRAILERS	220RBI	243BHS	248RKS	251RBS	252BHS	269RLS	272BHS	287QBS	308BHS	310BHS	335BHS
SHIPPING WEIGHT	4600	4685	4950	4943	4845	5185	5056	5480	6160	5977	6495
CARRYING CAPACITY	1800	1815	1550	2057	2155	2400	2484	2120	1440	1623	2105
HITCH WEIGHT	450	555	535	500	515	585	540	695	700	645	865
EXTERIOR LENGTH	25' 7"	27' 10"	28' 10"	29' 1"	29' 2"	30' 11"	30' 9"	32' 10"	35' 6"	35' 6"	37'
EXTERIOR WIDTH	8'	8'	8'	8'	8'	8'	8'	8'	8'	8'	8'
EXT. HEIGHT - A/C TOP	10' 7"	10' 7"	10' 7"	10' 7"	10' 7"	10' 7"	10' 7"	10' 7"	10' 8"	10' 8"	11'
FRESH WATER (GAL.)	43	43	43	43	43	43	43	43	43	43	43
WASTE WATER (GAL.)	30	30	30	30	30	30	30	30	30	30	30
GRAY WATER (GAL.)	30	30	60	30	30	30	30	30	30	60	30
LP CAPACITY (LBS.)	40	40	40	40	40	40	40	40	40	40	40
AWNING LENGTH	15'	19'	15'	14'	14'	15'	15'	15'	19'	19'	15'

STANDARDS & OPTIONS

CONSTRUCTION STANDARDS

- Aggressive Front Profile for Increased Towability
- Aluminum Framed Front, Rear, and Side Walls
- Aluminum Framed Slideouts
- Laminated Fiberglass Exterior Side Walls
- 2" Thick Laminated Aluminum Floor
- In-Frame Fresh, Grey, and Black Water Tanks
- 6.5" - 10" Steel I-Beam Frame with Welded Outriggers
- 1/4" ABS Enclosed Underbelly
- Darco Moisture Barrier
- One Piece TPO Roof
- E-Z Lube Axles
- Electric Brake System (4 wheels)
- R-11 Insulation in Floor
- R-7 Insulation in Sidewalls
- R-11 Insulation in Roof

EXTERIOR CAMPING PACKAGE

- Wide Stance E-Z Lube Axles
- 6 Gallon Gas/Electric DSI Water Heater with quick recovery
- Radius Entry Door with Gas Strut
- Outside Speakers
- Outside Shower (Hot & Cold Water)
- Tinted Safety Glass Windows
- 4 Stabilizer Jacks
- TV Antenna & Cable Hook-Up
- Electric Awning with Adjustable Arms
- Radial Tires
- Black Tank Flush

EXTERIOR FEATURES

- Dual Propane Tanks with Cover
- Front Diamond Plate
- In Frame Dual Battery Rack
- Oversized Exterior Pass Thru Storage with Lighting
- Contoured Fender Skirts for Increased Air-Flow
- LP Quick Connect
- Amber Patio Light
- Spare Tire
- Extended 4" Down Spouts
- Triple Entry Steps
- Oversized Grab Handle
- Jalousie Windows

INTERIOR CAMPING PACKAGE

- 13.5 BTU Ducted A/C
- Night Shades
- CD/DVD/AM/FM Bluetooth Stereo with Aux and I-Pod Hookup
- 32" LED TV
- Microwave
- 6 cu./ft. Double Door Refrigerator
- 3 Burner High Output Range
- 9" Deep Oversized Single Basin Sink with High Rise Faucet (N/A 220, 310)
- Glazed Hardwood Cabinet Doors
- Foot Flush Toilet
- Tub Surround with Shelves
- Full Extension Drawer Glides

INTERIOR FEATURES

- 78" Interior Height
- Fiberglass Reinforced Flooring
- Residential Style Furniture
- Water Heater-By-Pass for Winterization
- Night Shades in Living Area
- 17" Oven
- Radius Dinette

BATHROOM

- Towel Hooks
- Deluxe Curved Shower Curtain
- Power Vent Fan
- Solid Wood Medicine Cabinet
- Linen Storage

MASTER BEDROOM

- Upgraded Foam Mattress
- Dual 110V Outlets
- Mirrored Wardrobes
- Laundry Chute
- Under Bed Storage
- Full Blackout Window Treatments
- Individual Reading Lights

BUNK ROOMS

- Cable & TV Hookups (Per Floor Plan)
- Full Blackout Window Treatments
- Oversized Wardrobe with Rod (Some Floor Plans)

THERMAL PACKAGE

- Ducted Heat & Enclosed Underbelly
- 2" Duct off of Furnace to Underbelly
- 30K BTU Furnace
- Residential Heat Ducts



SAFETY EQUIPMENT

- Carbon Monoxide Detector
- Smoke Alarm
- Fire Extinguisher
- Electric Brakes
- Safety Chains
- Tinted Safety Glass Windows
- Egress Windows (Fire Escape)
- GFI Electrical Outlets

OPTIONS

- Aluminum Wheels
- 15K A/C
- 50 AMP Service with 2nd A/C Prep (308, 335 Only)
- Bumper Mounted Aussie Grill (N/A 287, 308)
- Tri-Fold Sofa (N/A 220, 243)

DUNE



SADDLE



CHARCOAL



YOUR LOCAL DEALER:



www.keystonerv.com/bullet

BULLET
ULTRA LITE
by Keystone

 **Keystone RV Company**
www.keystonerv.com

2642 Hackberry Drive | PO Box 2000
Goshen, IN 46527-2000
(574) 535-2100

November 2014