

# S & S 8.5ASC

## Features

### Exterior

Slant Front with  
Laminated Picture Window  
Skirted w/Taillights  
Single 20# LP Tank  
Battery Compartment  
Outside Shower Assembly  
Optional Electric Corner Jacks

### Tank Capacities

Fresh Water - 21 Gallons  
(upgrade to 30 gal)  
Grey Water - 13 Gallons  
Black Water - 10 Gallons

### Interior

1-Piece Shower Stall  
3-Burner Oven Range  
Double Stainless Steel Sink  
Couch Dinette  
Converta-Bunk  
Hardwood Cabinet Trim  
60 x 80 Queen Mattress  
Hydro-Flame 18M BTU Furnace  
30 Amp Power Converter & Cord  
5 Cubic Foot Dometic Refrigerator  
6 Gallon Atwood Water Heater  
Pre-Wire for Air, TV Antenna, Stereo

### Dry Weight

2040#

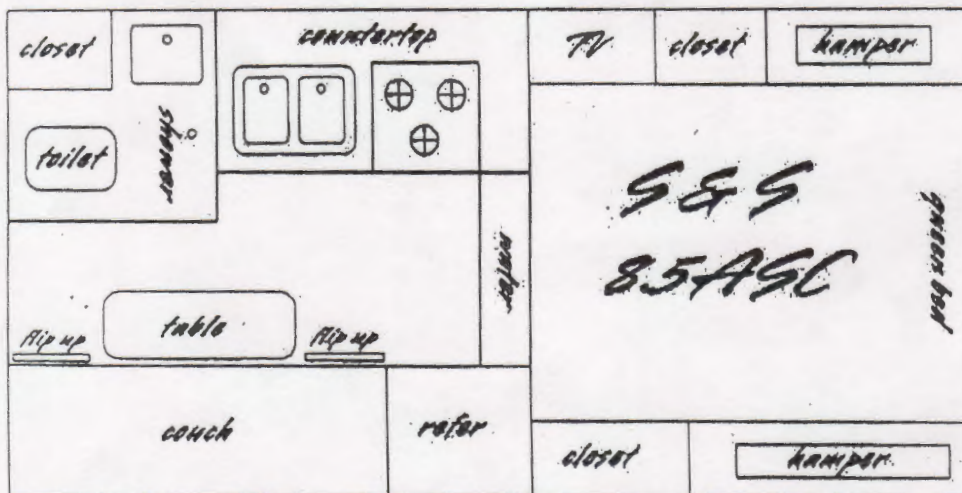

Fits  
Long  
or  
Shortbox  
Trucks