

HOLIDAY 1000

1992 MOTORHOMES

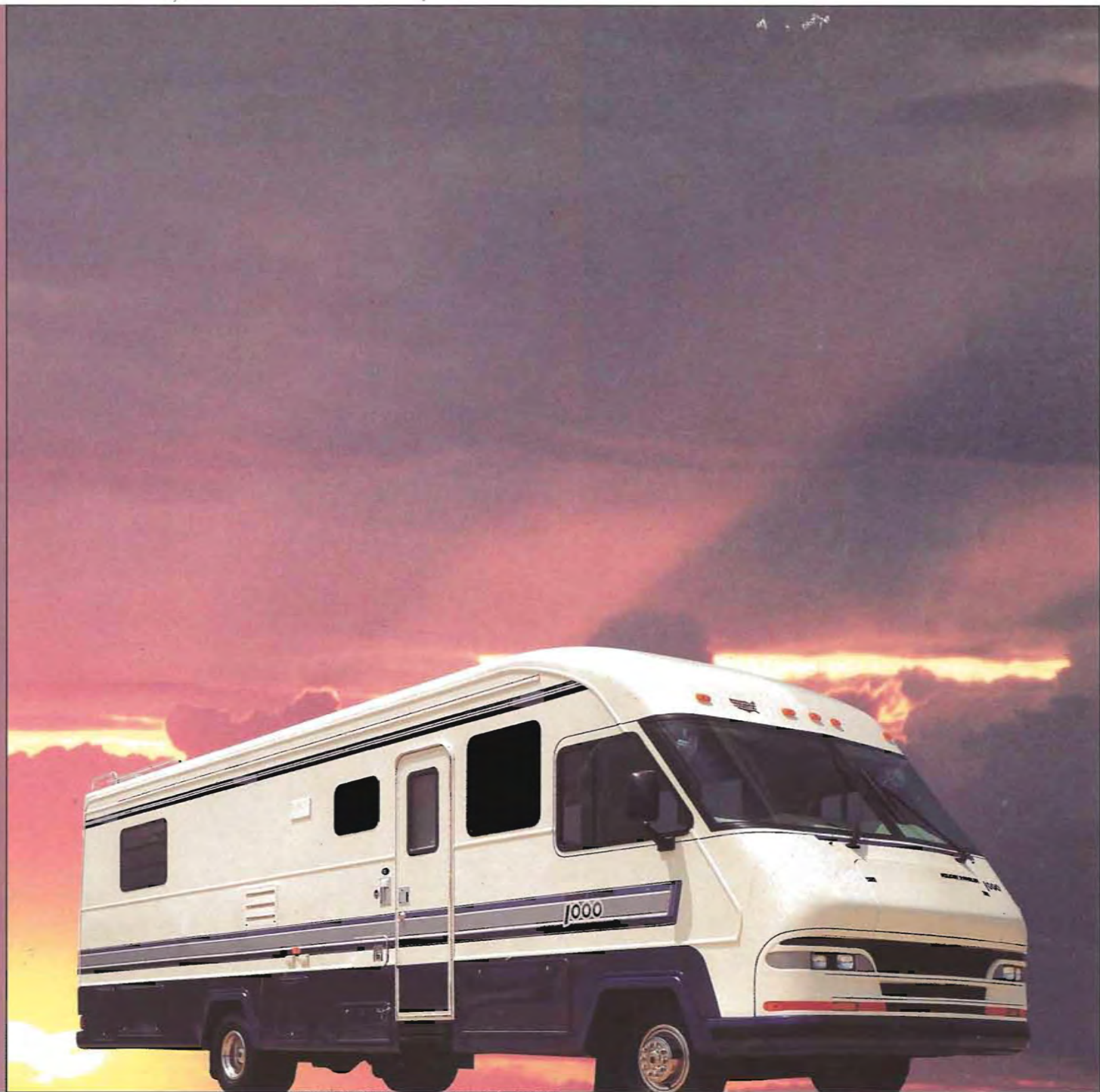



VALUE GOES A LONG WAY IN THE HOLIDAY 1000.

The Holiday 1000 sets a new standard of quality and affordability in Class A motorhomes. The smooth-riding, smooth-handling Holiday 1000 makes the going easy, out on the interstate or traveling winding back roads.

The Holiday 1000 has a style that's as contemporary as today. The grill and bumpers have been restyled. Graphics in new colors give it a distinctive look.

Inside, you'll find everything you need for first class travel. All the hallmarks of Holiday Rambler quality are here: fabrics that are just a little better, carpeting that's a little thicker. And the luxuries are built on solid engineering.

Count on your Holiday 1000 to keep its quality, comfort and value, miles down the road, whether you're traveling to the Great Lakes or the lake just across the county line.



Dashboard instrumentation is new for '92, provides easy reading and convenience.

The Holiday 1000 is the enjoyable way to get away.

Holiday 1000 Touring: The Great Lakes.

Take your Holiday 1000 on a trip through the Great Lakes. You'll see scenic waterways, thick piney woods and some fantastic sights.

Take a few days or a few weeks to explore. We've put together a handy tour guide to help you plan. There are just a few ideas to help you get started on a tour of your own.

The Great Lakes region begins at the St. Lawrence River in upstate New York, and extends west to Minnesota

and Lake Superior. All along the way, there's fun for the whole family.

Follow I-81 up to Alexandria Bay, NY, and take a boat tour through the Thousand Islands. Or take your own boat. By the way, if you're keeping count, there are actually over 1500 islands in the chain; some are U.S. territory, some Canadian.

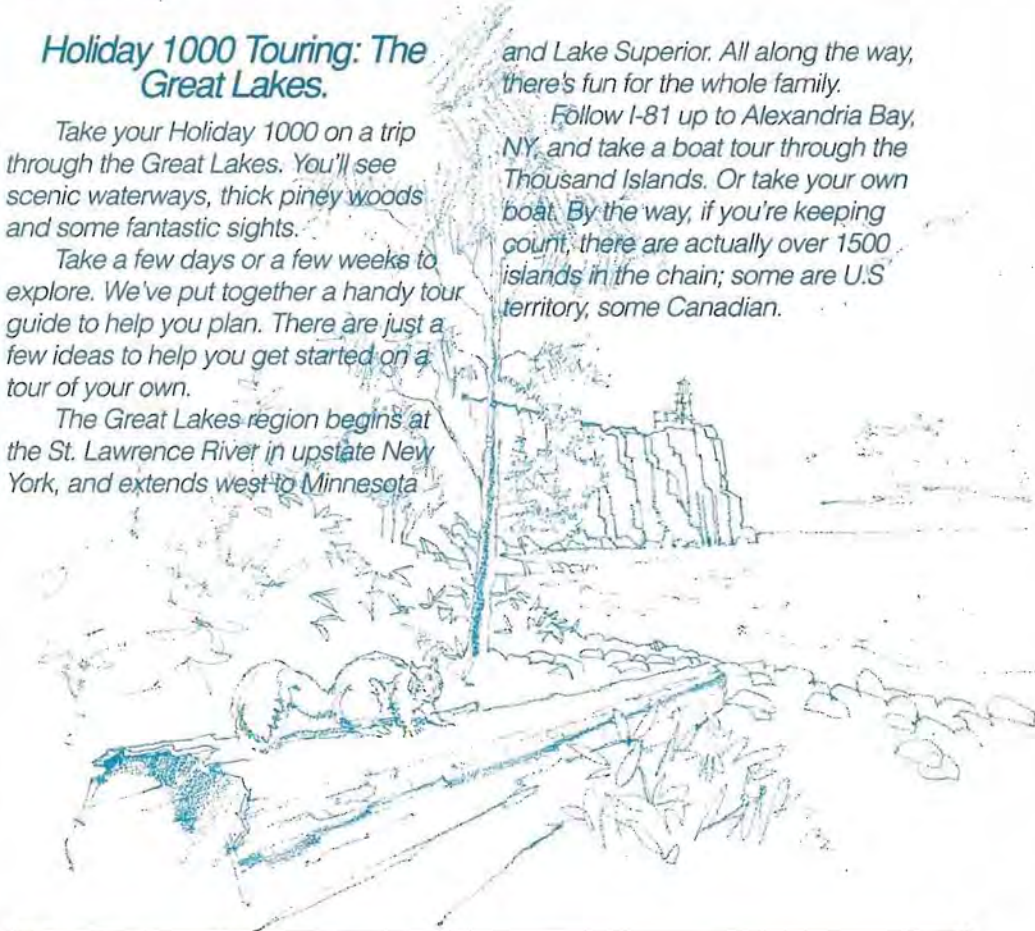

ADVENTURE TAKES A HOLIDAY.



Step into a Holiday 1000 motorhome, and the first thing you'll notice is how bright and spacious it is. The new Flexsteel® sofa makes the living area roomier than ever, while providing plenty of comfort. There are new window treatments throughout. A designer-coordinated chair completes the picture. A 13" remote control color TV is standard.

Choose solid hardwood raised panel doors in medium or bleached oak. Decorative glass accents the living room overheads. Dinettes are

framed in aluminum—not wood like some motorhomes. Tops and sides are padded for extra comfort.

The fully-equipped kitchen provides enough counter space for the fussiest chef. A full-size stainless steel sink, with a handy hardwood cover, and a Dometic® refrigerator, rattle-free Magic Chef® four-burner range, and touch-control microwave are all standard features.

The bathroom is well-planned and bright, with plenty of lighting. The bath features an easy-to-clean, one-piece fiberglass shower/tub combination. Note the extra touch of quality afforded by designer fixtures.

Bedrooms provide all the best in travel comfort. Carpeting is thick and rich. Bedspreads and throw pillows are color-coordinated. On most models, a comfortable queen-size bed is standard; twin beds are optional. A new color-coordinated chair rail provides a designer accent.

Options include a cable TV hookup, a VCR hookup, a Sony rear back-up vision system, a telephone jack, hydraulic leveling jacks, and more. See complete specifications and floor plans in the back of the workbook.

A pleasant surprise—plenty of room in the bathroom.



BEHIND THE RICH DECOR IS QUALITY CONSTRUCTION.

Holiday Rambler rolls out ahead of the competition with some of the most rugged construction in the industry. We take the time to test new ideas before they go into production. So when you get your Holiday 1000, you can count on features that are tested and proven. The extra effort pays off in years of extra comfort—and extra value—down the road.

Cabinet doors in all units are solid hardwood and mortise-and-tenon jointed. Other manufacturers use hollow core doors which are stapled or mitered together. Frames are stile constructed, then attached

to the aluminum frame to prevent sagging.

Drawers slide out smoothly on low-friction drawer glides. Positive catches ensure that cabinet doors open easily, shut firmly.

Extra water pump switches in the bathroom and the extra radio switch in the bedroom have been added for your convenience.

The framing under dinette seats is aluminum—not cheap plywood. It's stronger and more durable.

Exterior seams, compartments and fixtures are sealed with a Dow Corning silicone that's formulated to last 30 years.



Niagara Falls

Niagara Falls was discovered by LaSalle in 1678. Since then, the cascading waters have been discovered by millions. Whether you take your perspective from the American side or the Canadian side, this is truly one of those sights everyone should see at least once. A boat ride on the Maid of the Mist takes you behind the thundering water.

In the bedroom, fully-lined wardrobes and easy-to-reach cabinets provide ample storage for all your traveling gear.

The queen-size bed flips up for extra storage, locks down securely.





See the difference superior engineering can make.

1. Alumaframe® is Holiday Rambler's welded aluminum construction. It's the same type of construction found in many aircraft: interlocked two-way welded 1½" C-channel aluminum superstructure, with studs 24" on center. Nobody else has it. And for lightweight strength and durability, nobody can beat it.

2. The Alumaframe superstructure allows wiring to be easily routed anywhere. Protective thermoplastic grommets between the wiring and frame prevent electrical problems down the road.

3. Holiday Rambler design engineers create clay prototypes to test sizing, symmetry, and aerodynamics of motorhomes. This, combined with computer-aided design, gives Holiday Rambler a technological advantage over most competitive motorhomes.

4. A corrosion-resistant aluminum sheet barrier below the frame helps keep the road grit, grime and moisture outside the coach. Blandex® wood flooring eliminates seams and resists moisture which can cause costly reflooring.

5. Holiday Ramblers are double-insulated. Interior paneling, bead foam and craft paper are laminated together and fastened directly to the superstructure. The 1½" R-5 fiberglass insulation is hand-fitted in the frame. The durable fiberglass outer skin is riveted on.

6. Holiday Ramblers have plenty of basement storage—up to 110 cubic feet in some models.

LOW-MAINTENANCE FEATURES TO LOOK FOR.

We understand that you've got better ways to spend your time than performing constant maintenance, so we've designed in the quality you need to make your travels as carefree as can be.

Check the seals on windows and doors. All Holiday Rambler models feature radius self-sealing rubber gaskets around windows. This keeps moisture from pooling in the seams and helps keep your coach weathertight. The rounded seal means there's no need for caulking which can cause ugly stains and crack over time.

Take a close look at roof construction. Many manufacturers use flat, one-piece roofs which can actually prevent water from running off. Holiday Rambler's exclusive tapered roof is pitched 1 in. per 4 ft. It slopes away from the center and minimizes pooling water. The center seam is double-sealed—lapped and riveted. The roof overlaps the sides and is riveted to the outer skin to ensure a weathertight seal. How do we know it's weatherproof? The rain test booth at the Holiday Rambler plant subjects roof and window seams to a torrential soaking to make sure.

HOW TO MAKE YOUR CHOICE THE RIGHT CHOICE.

There are literally hundreds of RVs on the market, an overwhelming array to choose from. So we've created this handy checklist to make your choice easier.

Look at as many units as you have time, and take notes while you're looking. Consider how many people will be using the unit and what your daily routine will be. If you happen onto a floor plan you really like, make a note of it. Jot down which features come standard and which are options. This will make ordering additional options easier when it's time to buy.

Make a list of the units you've been considering. Then look back through your notes and rate each one using this checklist.

- ✓ 1. Does the unit run quietly?
- ✓ 2. Is it easy to maneuver?
- ✓ 3. Does it have a smooth ride?
- ✓ 4. Are the fit and finish of high quality?
- ✓ 5. Can you read the instrument panel easily?
- ✓ 6. Does the manufacturer sponsor service training seminars for your dealer?
- ✓ 7. Does the range have rattle-free burners?
- ✓ 8. Do the window treatments bang against the windows?
- ✓ 9. Does it have quality Flexsteel furnishings?

	1	2	3	4

TOTALS

Model #1	Model #2	Model #3	Model #4

The more "yes" answers you get, the more likely you are to get maximum enjoyment and value from your RV.

Choose your own coordinated decor from these fabrics and cabinetry.

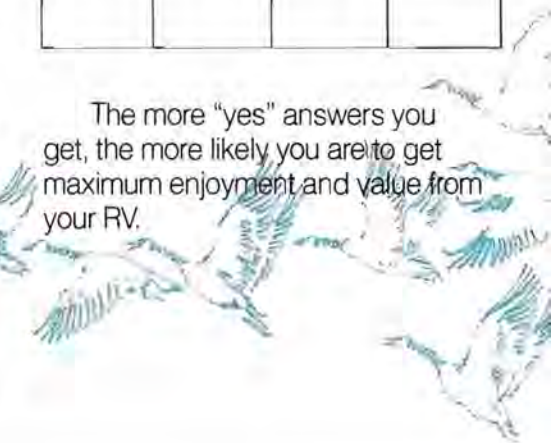

GET THE INSIDE STORY ON HOLIDAY RAMBLER.



Model shown, Aluma-Lite®

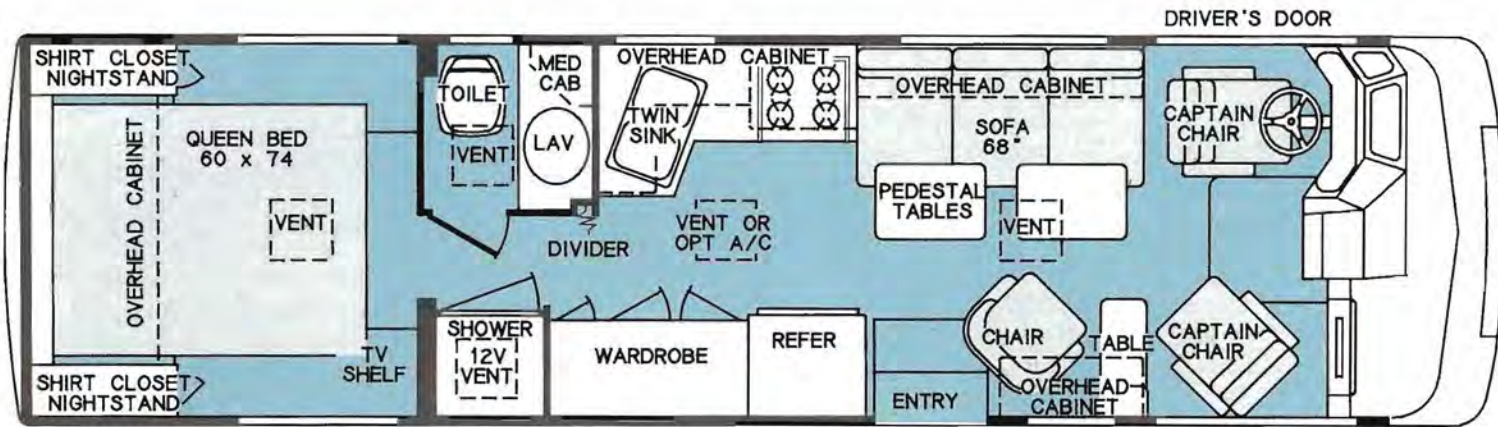

29 WBXS

HOLIDAY 1000
 OPTIONS AVAILABLE: A, B

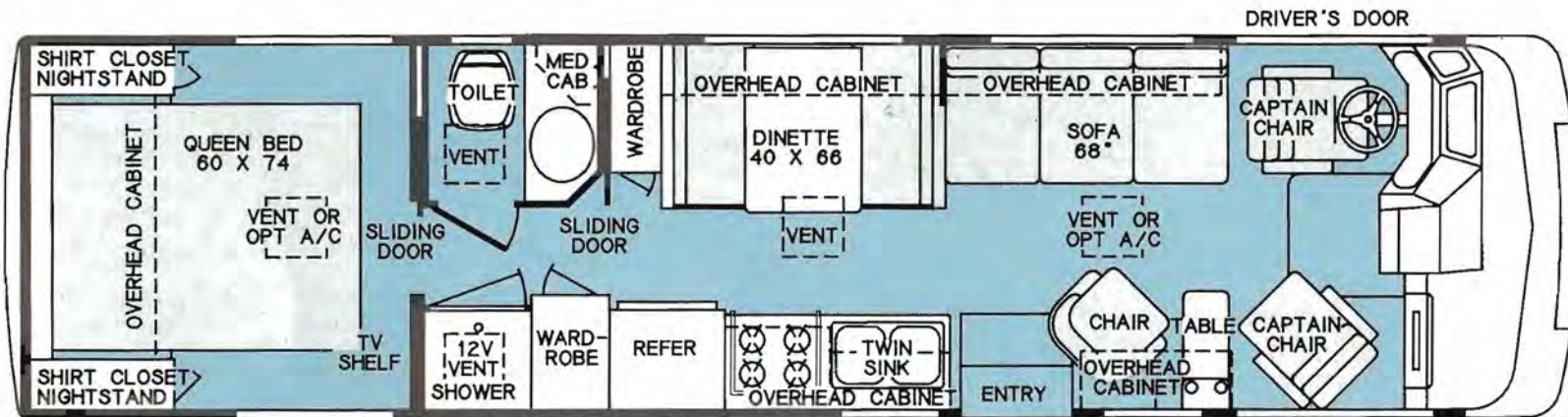

31 CBXS

HOLIDAY 1000
 OPTIONS AVAILABLE: A, B

OPTIONS AVAILABLE

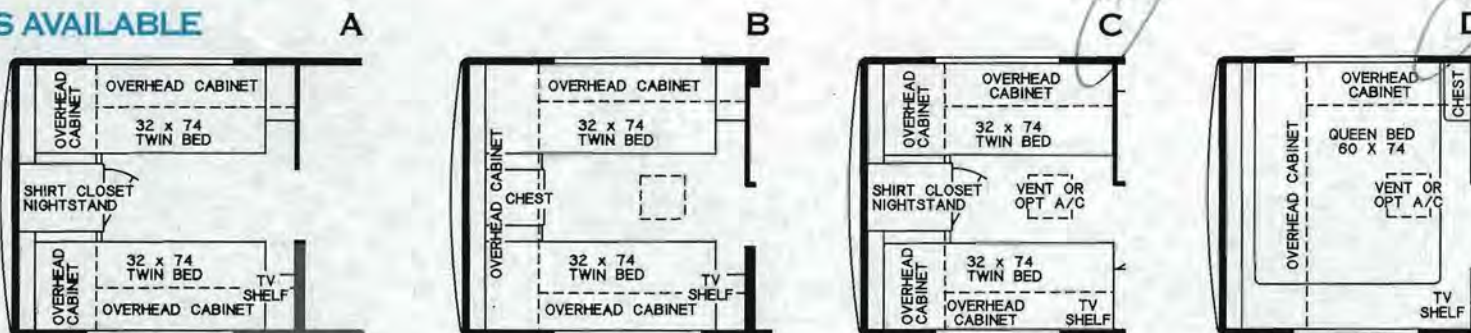

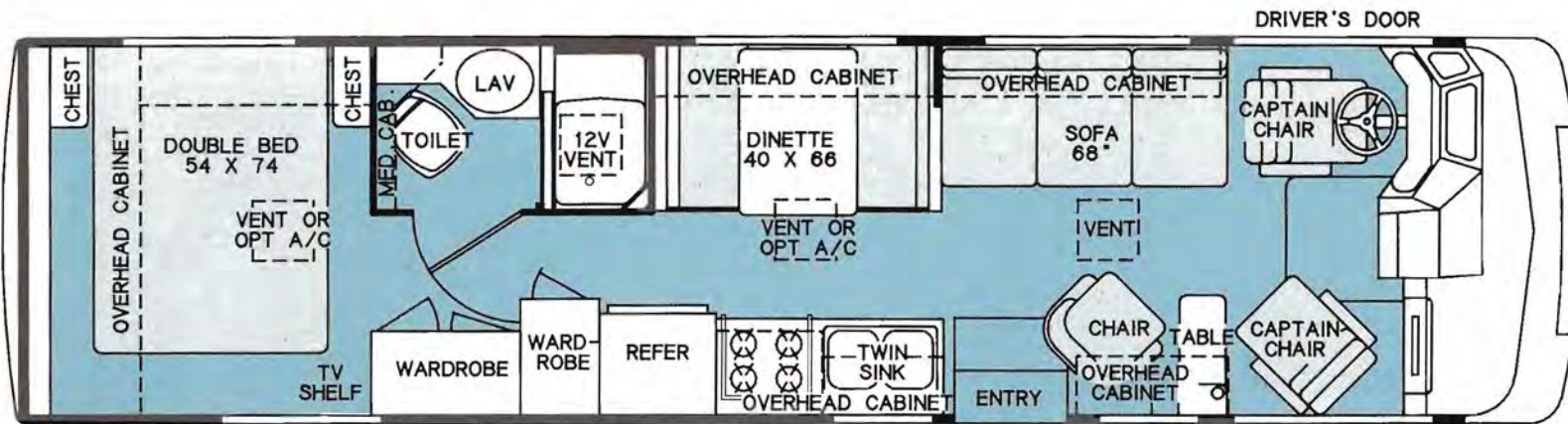

31 CSXS
 HOLIDAY 1000
 OPTIONS AVAILABLE: C, D, E

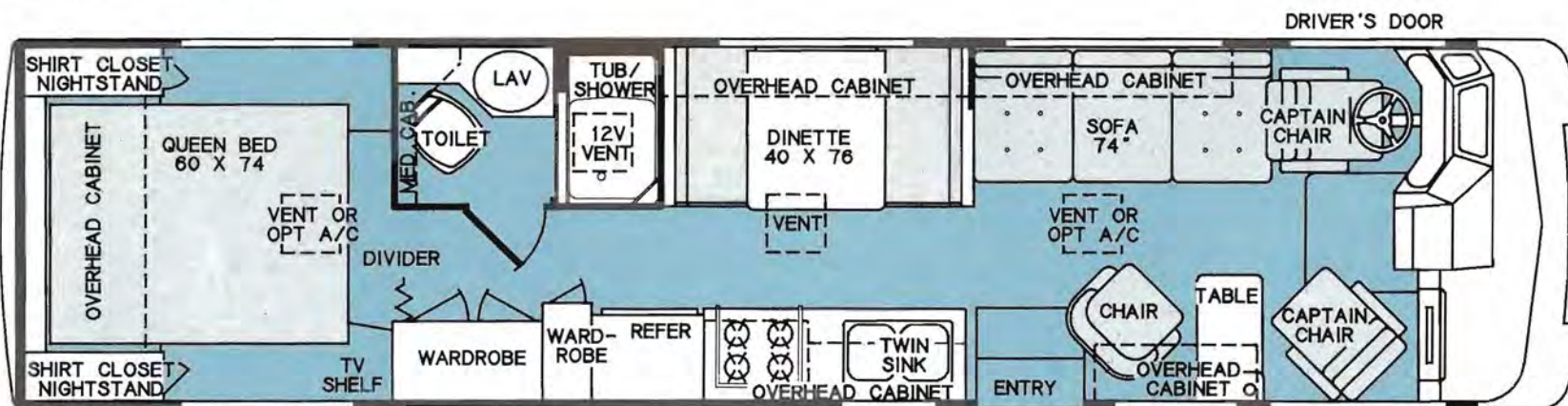

33 CSXS
 HOLIDAY 1000
 OPTIONS AVAILABLE: B

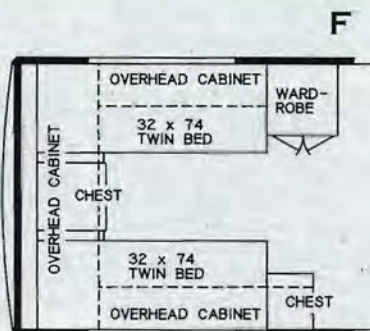
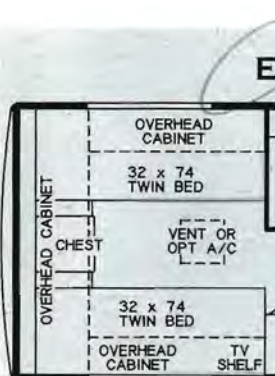

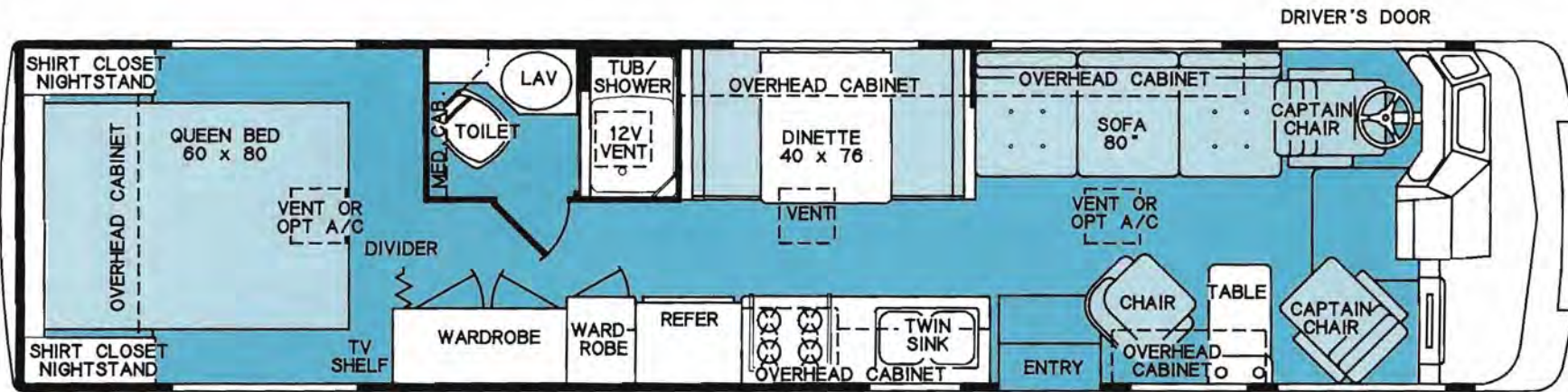

35 CSXS
 HOLIDAY 1000
 OPTIONS AVAILABLE: F

SPECIFICATIONS

AUTOMOTIVE

29WBXS 31CBXS 31CSXS 33CSXS 35CSXS

	29WBXS	31CBXS	31CSXS	33CSXS	35CSXS
AUTOMATIC TRANSMISSION	S	S	S	S	S
CRUISE CONTROL TILT WHEEL/ POWER STEERING	S	S	S	S	S
PANTOGRAPHIC PULSE WINDSHIELD WIPERS	S	S	S	S	S
DASH FANS	S	S	S	S	S
WRAPAROUND TINTED, CURVED RADIUS WINDSHIELD WITH NARROW "A" PILLARS	S	S	S	S	S
HIGH INTENSITY MAP LIGHT LOCATED IN COCKPIT	S	S	S	S	S
INTEGRATED ALUMINUM FRONT & REAR BUMPERS	S	S	S	S	S
MICHELIN RADIAL TIRES WITH VALVE STEM EXTENSIONS & WHEEL COVERS	S	S	S	S	S
RADIAL SPARE TIRE & WHEEL WITH FIBERGLASS TIRE COVER	S	S	S	S	S
STAINLESS STEEL WHEEL LINERS	O	O	O	O	O
SIX TON JACK WITH LUG WRENCH	S	S	S	S	S
HYDRAULIC LEVELING JACKS	O	O	O	O	O
MUD FLAPS ON FRONT & REAR	S	S	S	S	S
ELECTRONIC TUNE AM/FM STEREO CASSETTE RADIO WITH FOUR SPEAKERS	S	S	S	S	S
REAR VISION SYSTEM PREP	O	O	O	O	O
SONY REAR BACK-UP VISION SYSTEM	O	O	O	O	O
DUAL EXTERIOR MIRRORS	S	S	S	S	S
POWER/HEATED/REMOTE EXTERIOR MIRRORS	O	O	O	O	O
HALOGEN DRIVING LIGHTS	S	S	S	S	S
FULL ANALOG INSTRUMENT LOW PROFILE DASH PANEL	S	S	S	S	S
SPACIOUS GLOVE BOX	S	S	S	S	S
THIRD SAFETY BRAKE LIGHT STRATEGICALLY LOCATED	S	S	S	S	S
COLOR COORDINATED, CARPETED FLOOR MATS	O	O	O	O	O
DELUXE DRIVER & PASSENGER RECLINER SEATS	S	S	S	S	S
FULLY UNDER COATED	S	S	S	S	S
ROOF RACK & LADDER	S	S	S	S	S
HITCH RECEIVER WITH SKID BARS & FOUR-POINT CONNECTOR	S	S	S	S	S
POWER DOUBLE ENTRANCE STEP WITH COURTESY LIGHT	S	S	S	S	S
AUXILIARY START SWITCH	S	S	S	S	S
FIRESTONE RIDE-RITE AIR SUSPENSION FOR REAR AXLE	S	S	S	N/A	N/A

BODY CONSTRUCTION

29WBXS 31CBXS 31CSXS 33CSXS 35CSXS

	29WBXS	31CBXS	31CSXS	33CSXS	35CSXS
ALUMAFRAME SUPERSTRUCTURE	S	S	S	S	S
SMOOTH FIBERGLASS EXTERIOR	S	S	S	S	S
COLOR COORDINATED GRAPHICS	S	S	S	S	S
ONE-PIECE FRONT & REAR MOLDED FIBERGLASS CAPS	S	S	S	S	S
3/8" BEAD FOAM THERMAL BARRIER, CRAFT PAPER & VINYL CLAD PANELING LAMINATED TO SIDEWALL STRUCTURE	S	S	S	S	S
FITTED 1-1/2" R-5 FIBERGLASS INSULATION	S	S	S	S	S
VAPOR BARRIER IN ROOF	S	S	S	S	S
STEEL FLOOR FRAMING BOLTED TO CHASSIS MAIN RAILS	S	S	S	S	S
BLANDEX FLOORING (10 YEAR LIMITED WARRANTY)	S	S	S	S	S

APPLIANCES & ACCESSORIES

29WBXS 31CBXS 31CSXS 33CSXS 35CSXS

	29WBXS	31CBXS	31CSXS	33CSXS	35CSXS
DOMETIC 3804 TWO-WAY REFRIGERATOR	S	S	S	S	S
MAGIC CHEF 16" FOUR-BURNER RANGE WITH OVEN	S	S	S	S	S
MAGIC CHEF MICROWAVE WITH TOUCH CONTROL	S	S	S	S	S
MAGIC CHEF BAKE & BROIL MICROWAVE WITH TOUCH CONTROL	O	O	O	O	O
VENTLINE RANGE HOOD WITH 12V FAN & REMOTE DAMPER	S	S	S	S	S
BI-FOLD RANGE COVER	S	S	S	S	S
SYSTEMS MONITOR PANEL	S	S	S	S	S
WINEGARD TV ANTENNA & BOOSTER WITH 12V RECEIPT & THREE TV JACKS	S	S	S	S	S
CABLE TV HOOKUP & TELEPHONE JACK (INCLUDES PATIO JACK)	O	O	O	O	O
REMOTE CONTROL 13" COLOR TV IN LIVING AREA	S	S	S	S	S
WIRING PREP FOR VCR	O	O	O	O	O
DECORATIVE WALL CLOCK	S	S	S	S	S

CABINETS AND HARDWARE

29WBXS 31CBXS 31CSXS 33CSXS 35CSXS

CUSTOM CRAFTED MEDIUM OR BLEACHED OAK HARDWOOD DOORS, RAISED PANEL WITH DECORATIVE GLASS IN LR OVERHEAD	S	S	S	S	S
TELESTRUT HARDWARE ON OVERHEAD STORAGE DOORS & POSITIVE CATCHES ON ALL OTHER DOORS	S	S	S	S	S
GALLEY RAIL	S	S	S	S	S
LOW FRICTION DRAWER GUIDES	S	S	S	S	S
TOOTHBRUSH & GLASS HOLDER	S	S	S	S	S
TOWEL BAR WITH 2ND TOWEL RACK ON BATHROOM DOOR	S	S	S	S	S
FULL LENGTH DRESSING MIRROR IN BATH AREA	S	S	S	S	S
HARDWOOD KITCHEN SINK COVER	S	S	S	S	S
SPICE RACK	S	S	S	S	S
OAK SNACK TRAY ON ENGINE COVER	S	S	S	S	S
SPACIOUS, LIGHTED, & LINED WARDROBE(S), AUTO SWITCHED LIGHTS	S	S	S	S	S
CONCEALED TV SHELF IN BEDROOM	S	S	S	S	S
ADJUSTABLE SHELVES FOR WARDROBE (N/A WITH PANTRY)	O	O	O	O	O
COUNTERTOP EXTENSION	O	O	O	O	O
DRAWER(S) UNDER DINETTE	N/A	N/A	N/A	1	1
WASTE BASKET	S	S	S	S	S
PEDESTAL TABLES	S	N/A	N/A	N/A	N/A
CHAIR RAIL IN BEDROOM	O	O	O	O	O

BEDDING AND FURNITURE

29WBXS 31CBXS 31CSXS 33CSXS 35CSXS

INNERSPRING QUEEN BED WITH FLIP UP STORAGE	S	S	O	S	S
INNERSPRING DOUBLE BED	N/A	N/A	S	N/A	N/A
INNERSPRING TWIN BEDS WITH WARDROBE	O	O	O	N/A	N/A
INNERSPRING TWIN BEDS WITH NIGHTSTAND	O	O	O	O	O
BEDSPREAD(S) WITH HEADBOARD(S)	S	S	S	S	S
SLEEPER SOFA (FLEXSTEEL)	S	S	S	S	S
COLOR COORDINATED THROW PILLOWS FOR SOFA	S	S	S	S	S
UPHOLSTERED CHAIR WITH REMOTE SWIVEL & SLIDER	S	S	S	S	S
CARPET WITH STAIN PROTECTION & PAD	S	S	S	S	S

ELECTRICAL SYSTEMS AND LIGHTS

29WBXS 31CBXS 31CSXS 33CSXS 35CSXS

12V 40 AMP POWER CONVERTOR	S	N/A	N/A	N/A	N/A
12V 50 AMP POWER CONVERTOR	N/A	S	S	S	S
120V 30 AMP DISTRIBUTION PANEL & CORD	S	S	S	S	S
SEARS DIEHARD DEEP CYCLE RV/MARINE BATTERY	S	S	S	S	S
2ND SEARS DIEHARD DEEP CYCLE BATTERY	O	O	O	O	O
PORCH LIGHT, 120V RECEPT	S	S	S	S	S
OFF-DOOR SIDE SERVICE LIGHT	S	S	S	S	S
CARPETED STORAGE COMPARTMENTS	S	S	S	S	S
12V BATTERY DISCONNECT SWITCH	S	S	S	S	S
FLUORESCENT LIGHTING PACKAGE	O	O	O	O	O
GENERATOR PREP WITH AUTOMATIC TRANSFER SWITCH	S	S	S	S	S
ONAN EMERALD 4.0 GENERATOR WITH AUTO TRANSFER SWITCH	O	O	O	O	O
ONAN EMERALD 5.0 GENERATOR WITH AUTO TRANSFER SWITCH	O	O	O	O	O
ONAN EMERALD 6.5 GENERATOR WITH AUTO TRANSFER SWITCH	N/A	O	O	O	O

HEATING, VENTS, AND AIR CONDITIONING

29WBXS 31CBXS 31CSXS 33CSXS 35CSXS

ELECTRONIC IGNITION FURNACE (BTU'S)	31M	31M	31M	31M	35M
UNDER FLOOR DUCTED HEATING SYSTEM	S	S	S	S	S
TRANSLUCENT ROOF VENTS	S	S	S	S	S
12V TRANSLUCENT ROOF VENTS ILO STANDARD VENTS	O	O	O	O	O
12V TRANSLUCENT ROOF VENT IN BATH	S	S	S	S	S
12V ATTIC FAN WITH WALL THERMOSTAT	O	O	O	O	O
WIRED FOR AIR CONDITIONER (# OF PRE-WIRED)	1	2	2	2	2
COLEMAN 13.5M BTU SUPER MACH THREE-SPEED AIR CONDITIONER	O	O	O	O	O
2ND COLEMAN 13.5M BTU SUPER MACH THREE-SPEED AIR CONDITIONER	N/A	O	O	O	O
DUAL AIR CONDITIONER SELECTOR SWITCH	N/A	O	O	O	O
DUAL 12V AUXILIARY FRONT WINDSHIELD FANS	S	S	S	S	S
AUTOMOTIVE AUXILIARY HEATER	O	O	O	O	O

PLUMBING AND L.P. SYSTEMS

29WBXS 31CBXS 31CSXS 33CSXS 35CSXS

DEEP STAINLESS STEEL SINK WITH SINGLE HANDLE FAUCET	S	S	S	S	S
DEMAND WATER SYSTEM & SHURFLO WATER PUMP	S	S	S	S	S
DELUXE WATER FILTER SYSTEM	O	O	O	O	O
NO-FUSS FLUSH HOLDING TANK RINSING SYSTEM	O	O	O	O	O
SIX GALLON WATER HEATING WITH ELECTRONIC IGNITION	S	S	S	S	S
WATER HEATER BY-PASS KIT	O	O	O	O	O
FIBERGLASS ONE-PIECE TUB/SHOWER	S	S	S	S	S
GLASS SHOWER DOOR	S	S	S	N/A	N/A
SHOWER CURTAIN WITH LINER	N/A	N/A	N/A	S	S
GREY HOLDING TANK (CAPACITY IN GALLONS)	35	60	60	56	56
BLACK HOLDING TANK (CAPACITY IN GALLONS)	35	35	35	38	38
FRESH WATER TANK (CAPACITY IN GALLONS)	50	70	70	70	70
INSULATED HOLDING TANKS	S	S	S	S	S
THETFORD TOILET	S	S	S	S	S
L.P. TANK (CAPACITY IN GALLONS)	27	27	27	27	27
WINTERIZE	O	O	O	O	O

SAFETY FEATURES

29WBXS 31CBXS 31CSXS 33CSXS 35CSXS

5: BC FIRE EXTINGUISHER	S	S	S	S	S
DEADBOLT LOCK ON ENTRANCE	S	S	S	S	S
110V GFI PROTECTED CIRCUIT	S	S	S	S	S
L.P. GAS SENSOR	S	S	S	S	S
SMOKE DETECTOR	S	S	S	S	S
AUXILIARY START SWITCH	S	S	S	S	S

The information printed in this brochure reflects product design, fabrication and component parts at the date of printing. The manufacturer reserves the right, at any time, to make changes in product design or material or component specifications of fabrication as its sole option, without notice. This includes the substitution of components of a different brand or trade name which will result in comparable performance. All information printed in this brochure is subject to change after the date of printing.

WINDOWS, DOORS, AND AWNINGS

	29WBXS	31CBXS	31CSXS	33CSXS	35CSXS
RADIUS SAFETY GLASS SLIDER, DARK TINTED WINDOWS (NA IN BEDROOM)	S	S	S	S	S
RADIUS SAFETY GLASS TORQUE, DARK TINTED WINDOWS (BEDROOM)	S	S	S	S	S
DRIVER'S SIDE DOOR WITH SLIDER WINDOW	S	S	S	S	S
ROLLER SHADES IN LIVING ROOM & BEDROOM	S	S	S	S	S
VENETIAN BLINDS IN KITCHEN & BATH	S	S	S	S	S
PADDED LAMBREQUINS IN LIVING ROOM	S	S	S	S	S
PADDED VALANCES IN BEDROOM, BATH & KITCHEN; DRAPE PANEL IN BEDROOM	S	S	S	S	S
RADIUS ENTRANCE DOOR	S	S	S	S	S
DIVIDING FOLDING DOOR	S	N/A	N/A	S	S
COLOR COORDINATED AWNINGS	O	O	O	O	O

CHEVROLET CHASSIS

	29WBXS	31CBXS	31CSXS	33CSXS	35CSXS
ENGINE-CID V8 GAS, FUEL INJECTION	454	454	454	454	454
WHEELBASE (INCHES)	178	190	190	178	178
GVWR (GROSS VEHICLE WEIGHT RATING)	14800	16000	16000	17500	17500
GCWR (GROSS COMBINED WEIGHT RATING)	19000	20000	20000	19000	19000
FGAR (FRONT GROSS AXLE RATING)	5300	5500	5500	5300	5300
RGAR (REAR GROSS AXLE RATING)	10000	10500	10500	10000	10000
UVW (UNLOADED VEHICLE WEIGHT)	11155	11560	11560	12475	12785
TIRE SIZE	800/19.5	800/19.5	800/19.5	800/19.5	800/19.5
FUEL TANK	80	80	80	80	80
ALTERNATOR	105	105	105	105	105
REAR AXLE RATIO	4.56	4.63	4.83	4.56	4.56
EASY ACCESS FRONT AIR BAG FILL	O	O	O	O	O
COOLING SYSTEM WITH AUXILIARY FANS	S	S	S	S	S
HANDLING PACKAGE	O	O	O	O	O

FORD CHASSIS

	29WBXS	31CBXS	31CSXS	33CSXS	35CSXS
ENGINE-CID V8 GAS, FUEL INJECTION	460	460	460	460	460
WHEELBASE (INCHES)	178	178	178	208	228
GVWR (GROSS VEHICLE WEIGHT RATING)	17000	18000	18000	17000	17000
GCWR (GROSS COMBINED WEIGHT RATING)	25000	25000	25000	25000	25000
FGAR (FRONT GROSS AXLE RATING)	6000	6000	6000	6000	6000
RGAR (REAR GROSS AXLE RATING)	11000	11000	11000	11000	11000
UVW (UNLOADED VEHICLE WEIGHT)	11740	12160	12160	13090	13530
TIRE SIZE-16"	235/85R	235/85R	235/85R	235/85R	235/85R
FUEL TANK	75	75	75	75	75
ALTERNATOR	100	100	100	100	100
REAR AXLE RATIO	5.13	5.13	5.13	5.13	5.13
OVERDRIVE	S	S	S	S	S

DIMENSIONS

	29WBXS	31CBXS	31CSXS	33CSXS	35CSXS
OVERALL LENGTH	30'1"	32'1"	32'1"	33'9"	35'4"
OVERALL HEIGHT CHEVROLET (INCLUDES A/C)	11'5"	11'5"	11'5"	11'5"	11'5"
OVERALL HEIGHT FORD (INCLUDES A/C)	11'7"	11'7"	11'7"	11'7"	11'7"
INTERIOR HEIGHT	78"	78"	78"	78"	78"
INTERIOR WIDTH	88 3/4"	88 3/4"	88 3/4"	88 3/4"	88 3/4"
EXTERIOR WIDTH	93"	93"	93"	93"	93"

GET TOGETHER WITH A FEW FRIENDS: THE HOLIDAY RAMBLER RV CLUB.

For nearly 40 years, Holiday Rambler has been bringing people together, helping them share the enjoyment of the open road, and the excitement of discovering America firsthand.

Today, over 13,000 families are members of the Holiday Rambler RV Club—a group of RV owners all dedicated to the pursuit of happiness on the open road. The only membership qualifications are a Holiday Rambler and a good stretch of highway.

For membership details, ask your Holiday Rambler dealer, or call us direct: 219-862-7330.

HOLIDAY RAMBLER HAS BEEN GOING STRONG FOR MORE THAN 38 YEARS.

Holiday Rambler Corporation, one of the nation's leading RV manufacturers, was started in 1953 by a father and son team. In 1986, Holiday Rambler became part of the Harley-Davidson corporate family. We've built a reputation for quality by constantly refining, reconfiguring, testing and retesting every feature of our RVs.

Everyone who builds a Holiday Rambler is responsible for quality control. If a problem does arise, we fix it on the spot. That's how we make "Quality First."



Holiday Rambler Corporation
65906 State Road 19
P. O. Box 465
Wakarusa, IN 46573
219/862-7211
© Holiday Rambler Corporation 1991

Your Holiday Rambler Dealer Is:

HOLIDAY WORLD
12620 Highway 99 South
EVERETT, WASHINGTON 98204
12 (206) 355-5944 743-1717
EVERETT, WASH. 98204
(206) 355-5944 743-1717